

VEX[®]

ROBOTICS

Super Clawbot Build Instructions

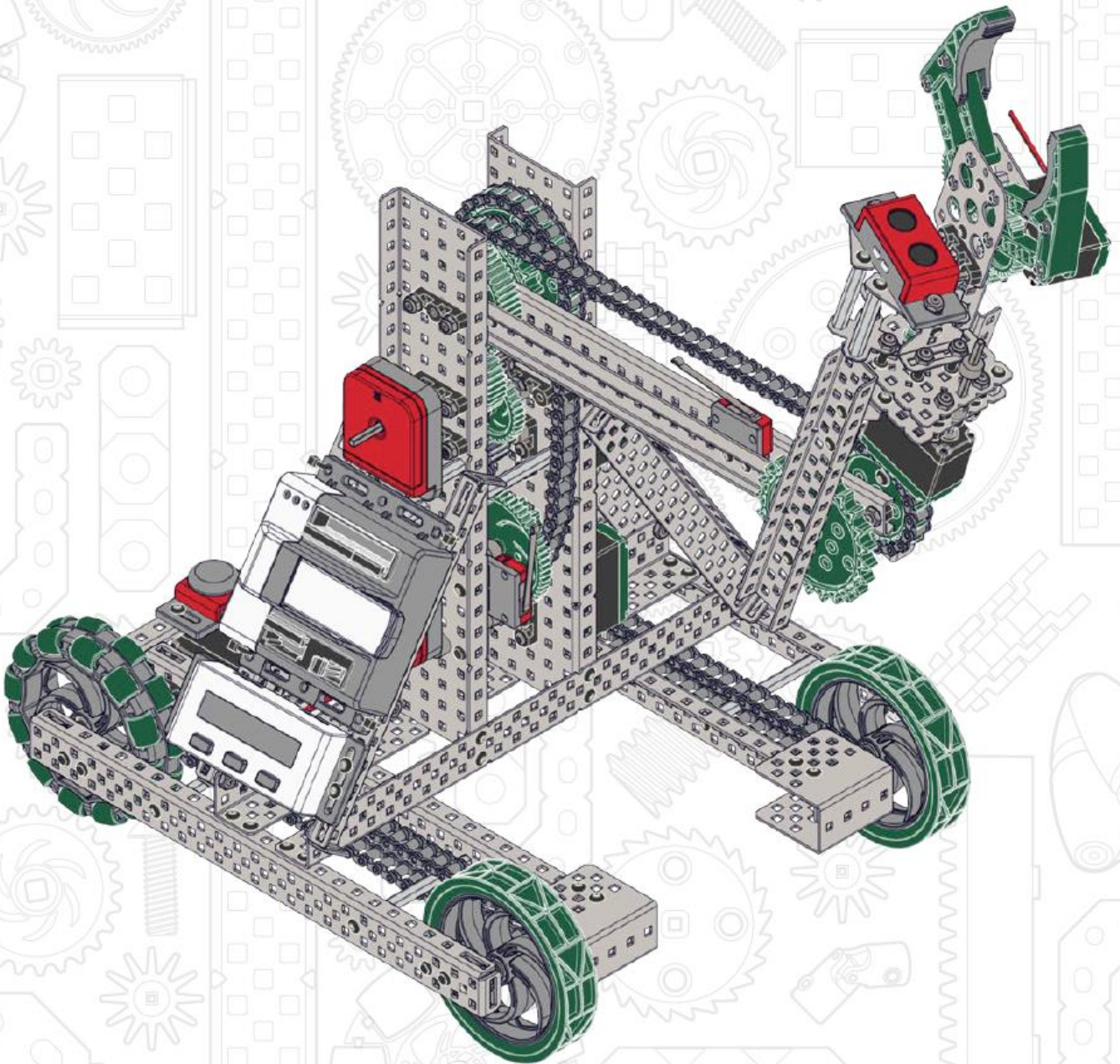

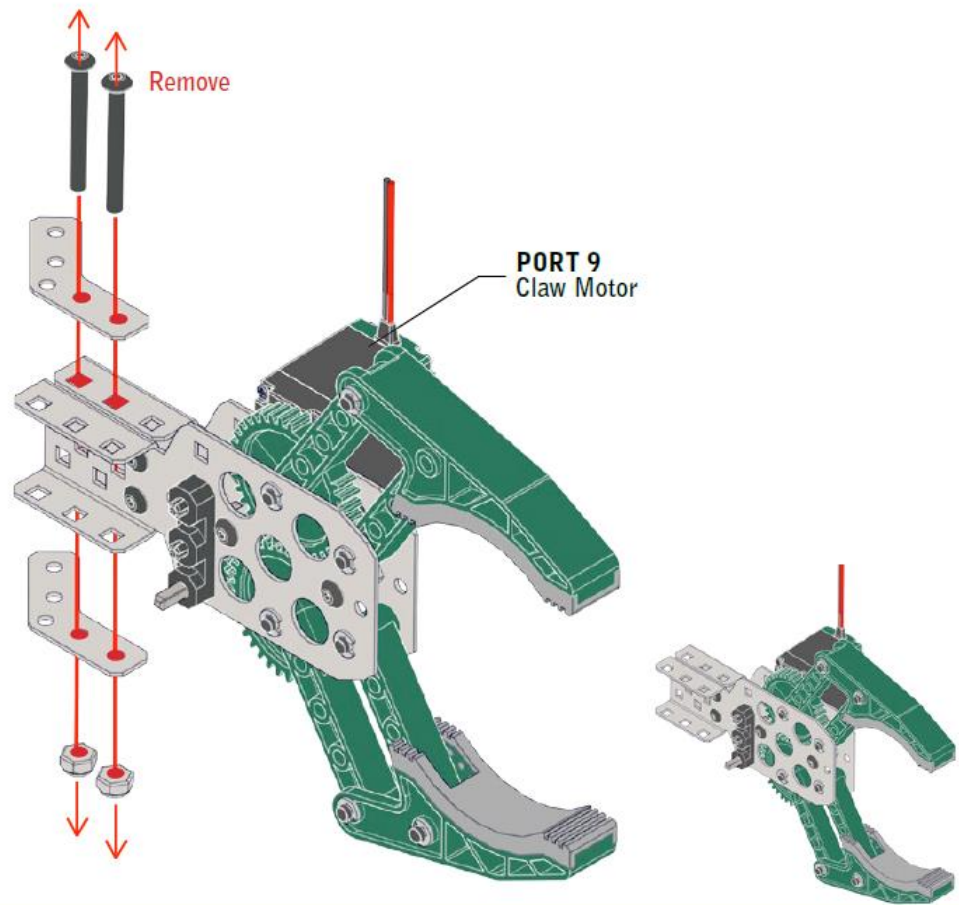

(2x)
Screw 8-32 x 0.250"



(2x)
Nut 8-32 Keps



(1x)
C-Channel 1x2x1x15



(1x)
Chassis Rail 2x1x25

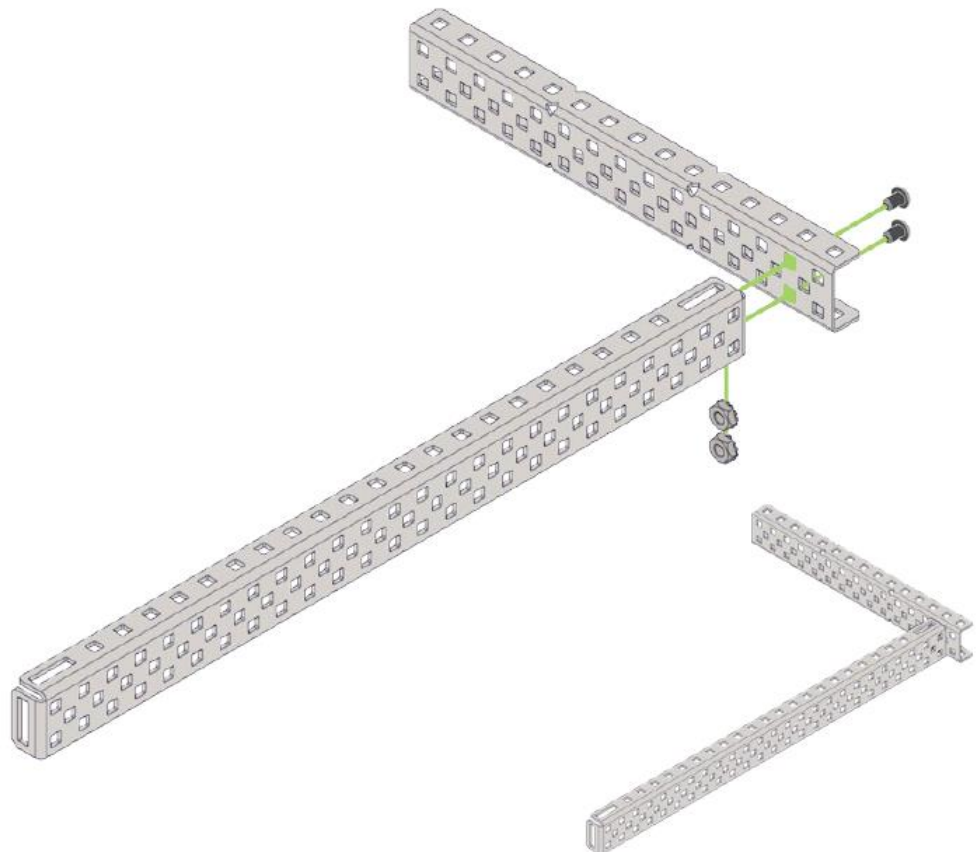



(2x) Screw 6-32 x 0.500" Silver



(2x) Screw 8-32 x 0.250"



(2x) Bearing Flat



(2x) Inner Rivet



(2x) Outer Rivet



(1x) 2-Wire Motor 393 with Integrated Encoder Module



Use the encoder Instructions to assemble encoder.

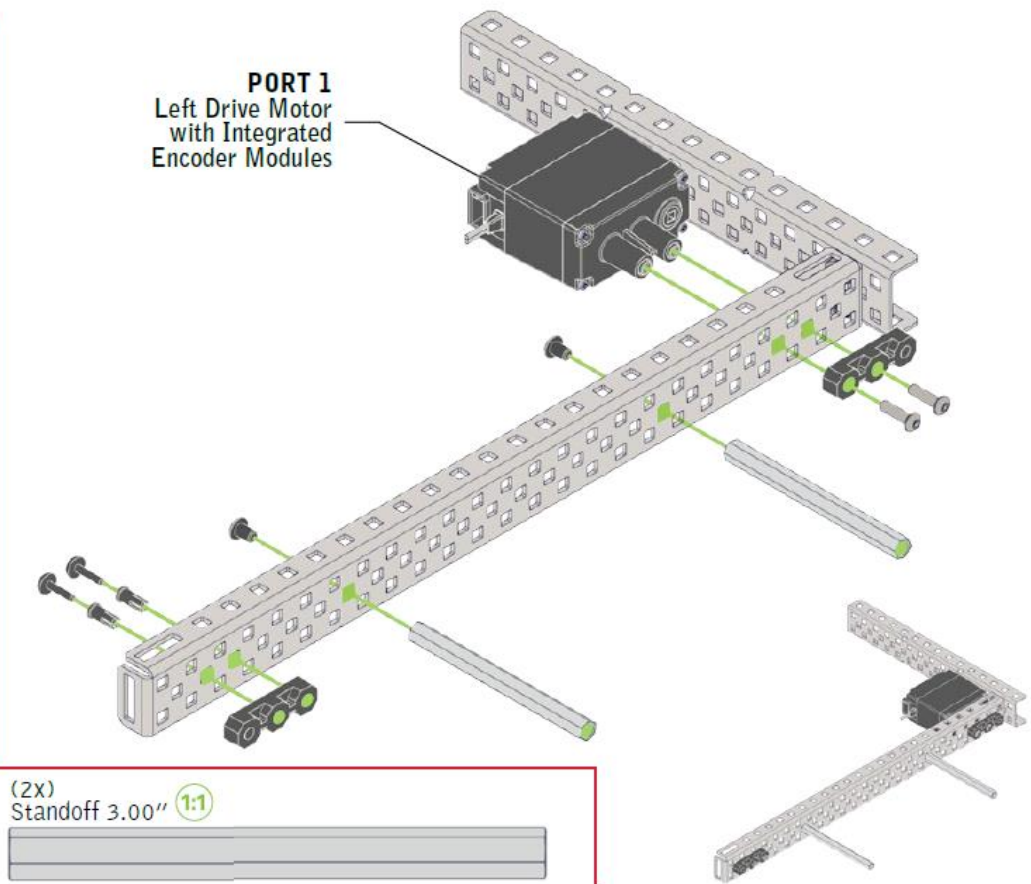

(4x) Plastic Spacer, 8mm



(1x) 4" Wheel



(4x) Shaft Collar



(1x) 4" Omni-Directional Wheel



(2x) High Strength 6T Sprocket

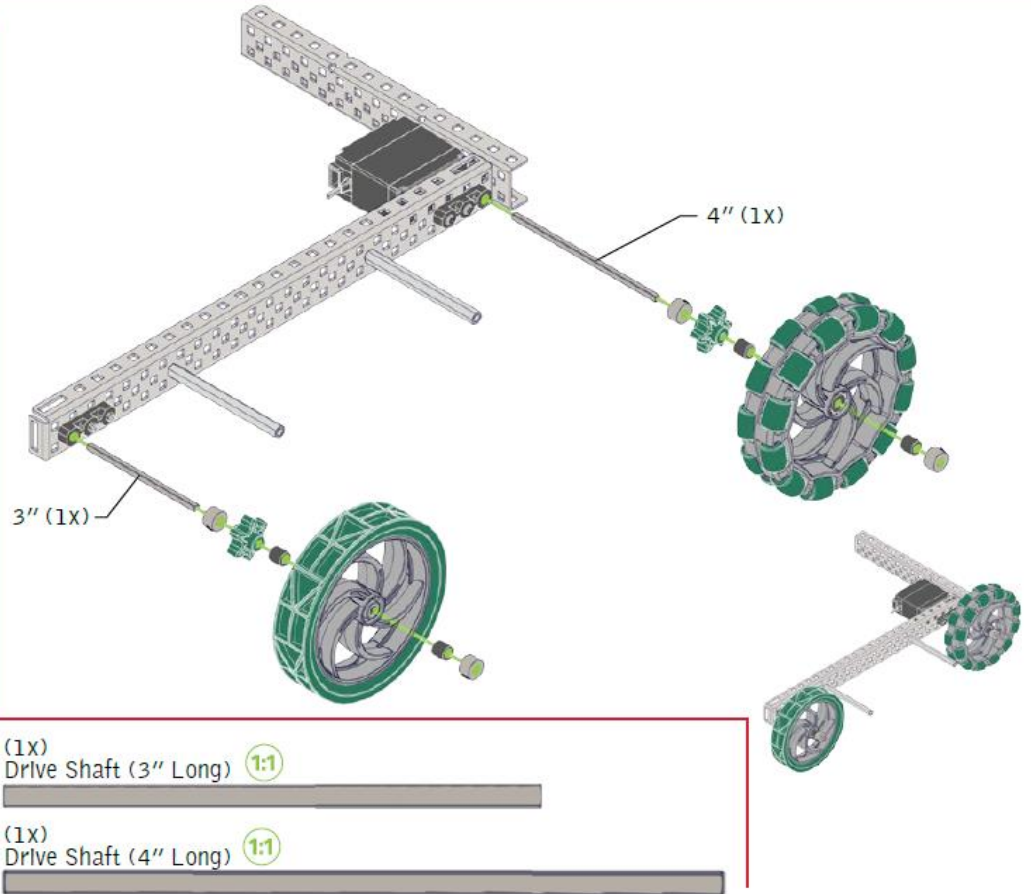



(1x)
Chassis Rail 2x1x25



(4x)
Outer Rivet



(4x)
Inner Rivet



(2x)
Screw 8-32 x 0.250"



(2x)
Bearing Flat

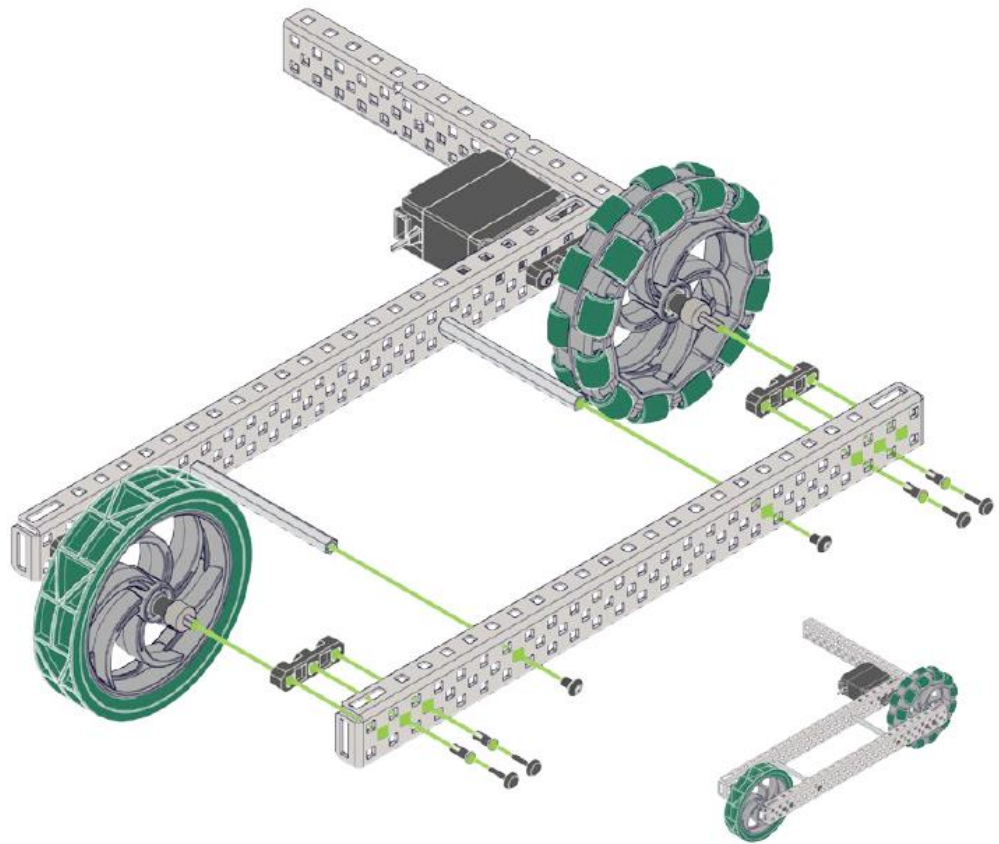

(65x)
High Strength Chain Link

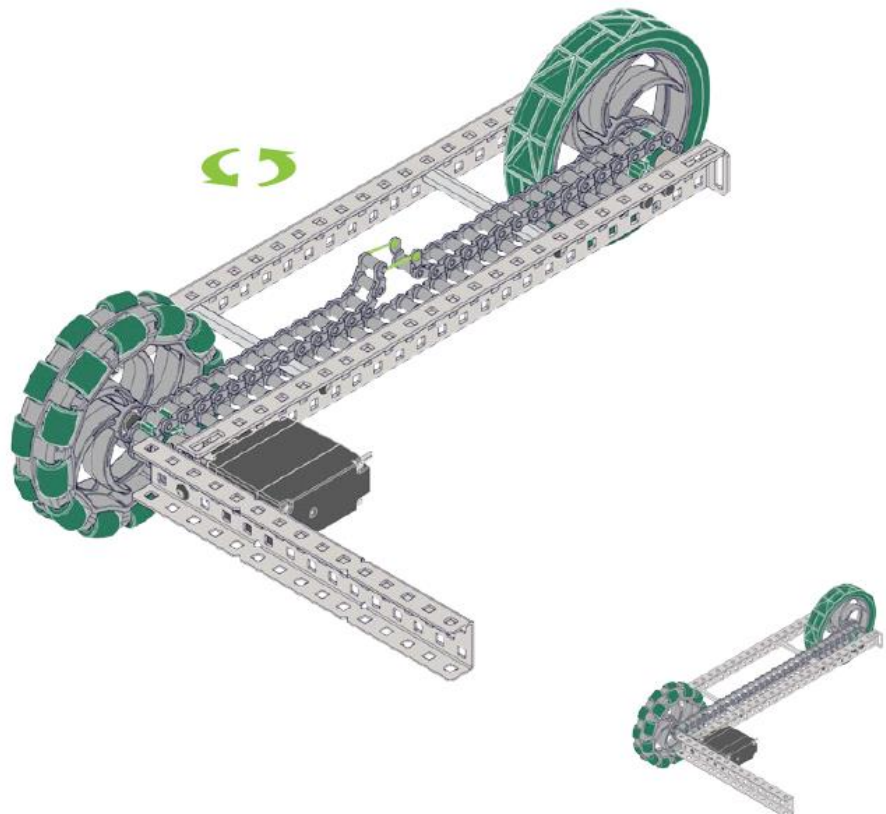
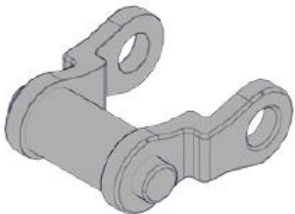



(1x)
Chassis Rail 2x1x25



(2x)
Screw 8-32 x 0.250"



(2x)
Nut 8-32 Keps

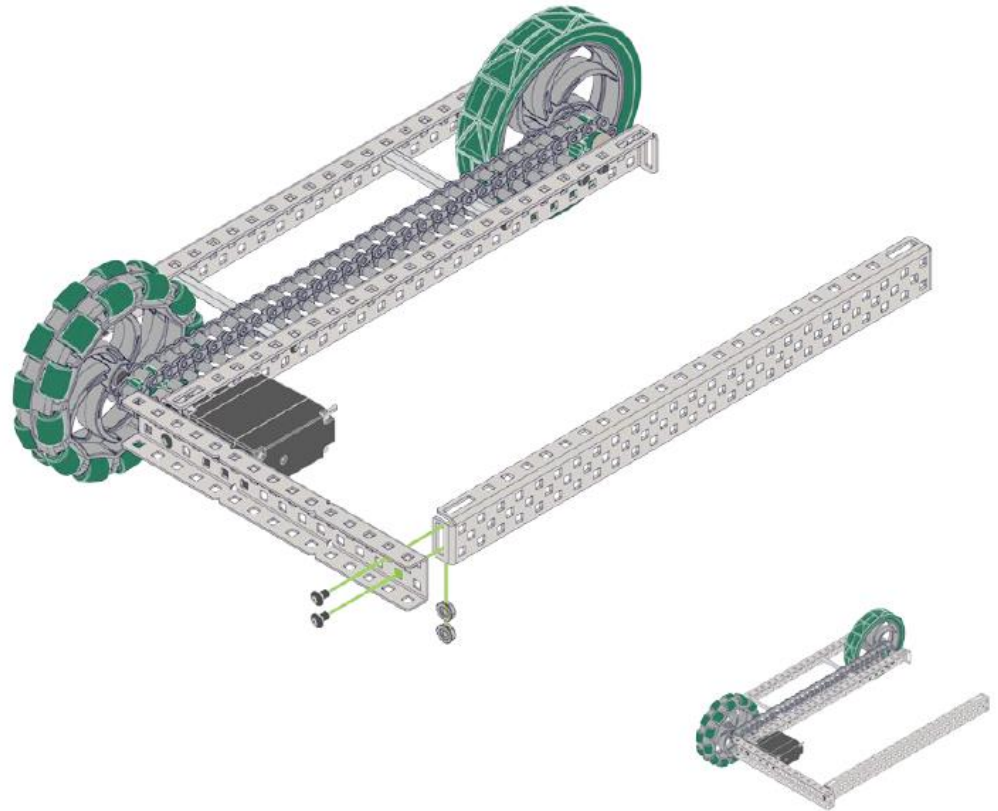

(2x)
Outer Rivet



(2x)
Inner Rivet



(2x)
Screw 8-32 x 0.250"



(2x)
Screw 6-32 x 0.500" Silver



(2x)
Bearing Flat



(1x)
2-Wire Motor 393 with
Integrated Encoder Module



Use the encoder
instructions to
assemble encoder.

(2x)
Standoff 3.00" 1:1

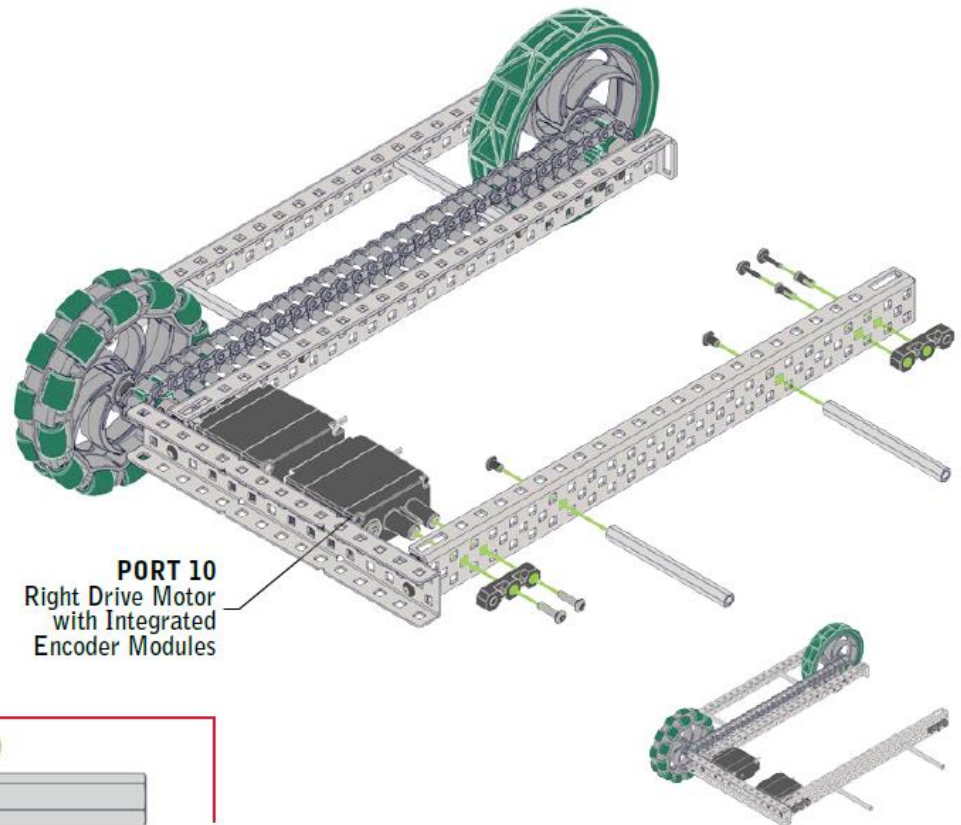
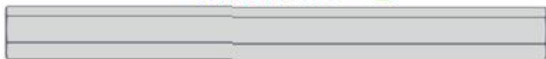

PORT 10
Right Drive Motor
with Integrated
Encoder Modules



(4x) Plastic Spacer, 8mm



(1x) 4" Wheel



(4x) Shaft Collar



(1x) 4" Omni-Directional Wheel



(2x) High Strength 6T Sprocket

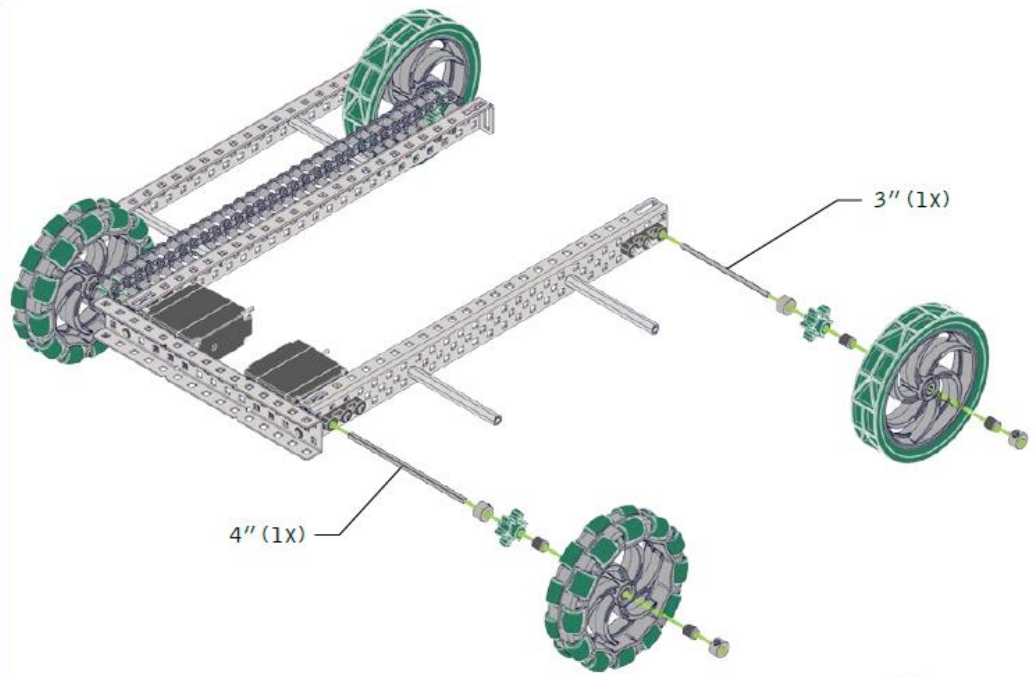

4" (1x)

3" (1x)

(1x) Drive Shaft (3" Long) 1:1

(1x) Drive Shaft (4" Long) 1:1

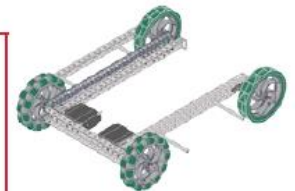
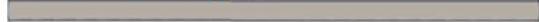

(1x) Chassis Rail 2x1x25



(4x) Outer Rivet



(4x) Inner Rivet



(2x) Screw 8-32 x 0.250"



(2x) Bearing Flat

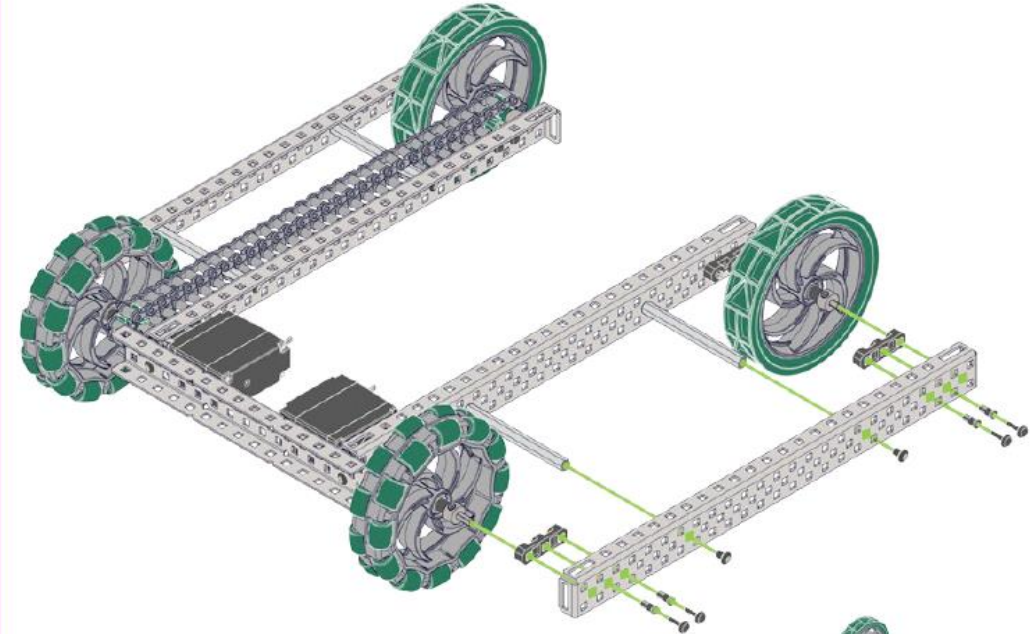



(65X)
High Strength Chain Link

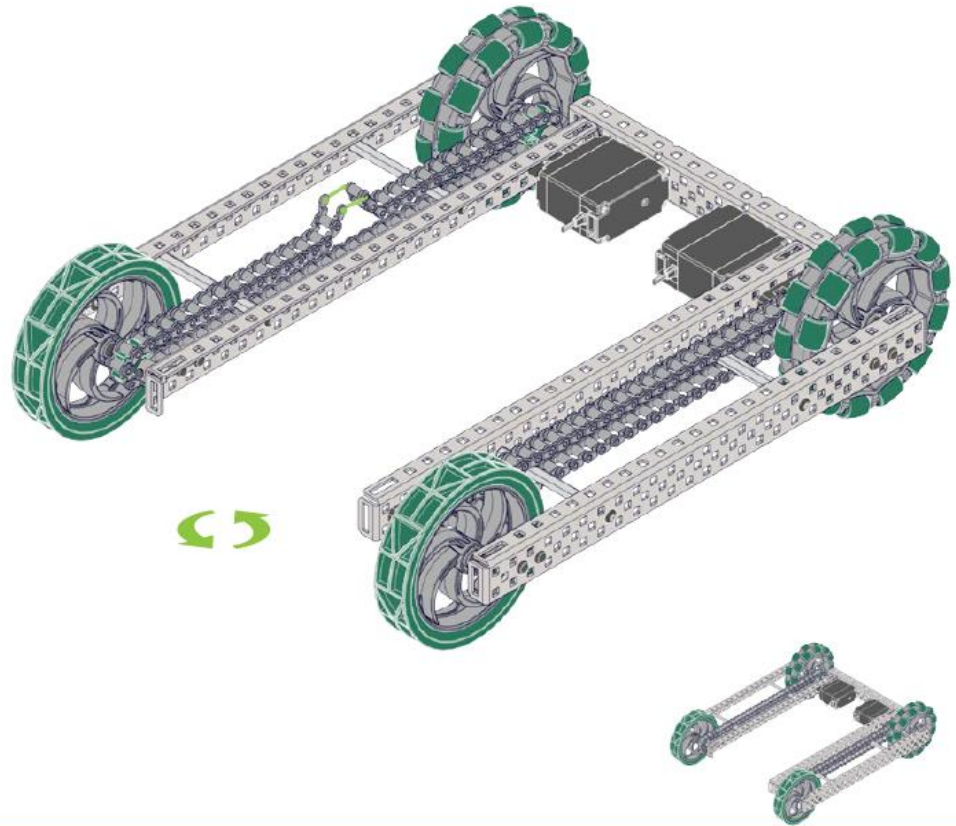
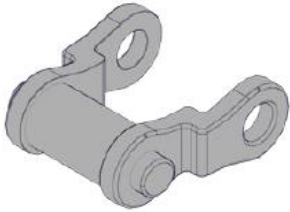

(8X)
Screw 8-32 x 0.250"



(8X)
Nut 8-32 Keps



(1X)
Angle 2x2x25

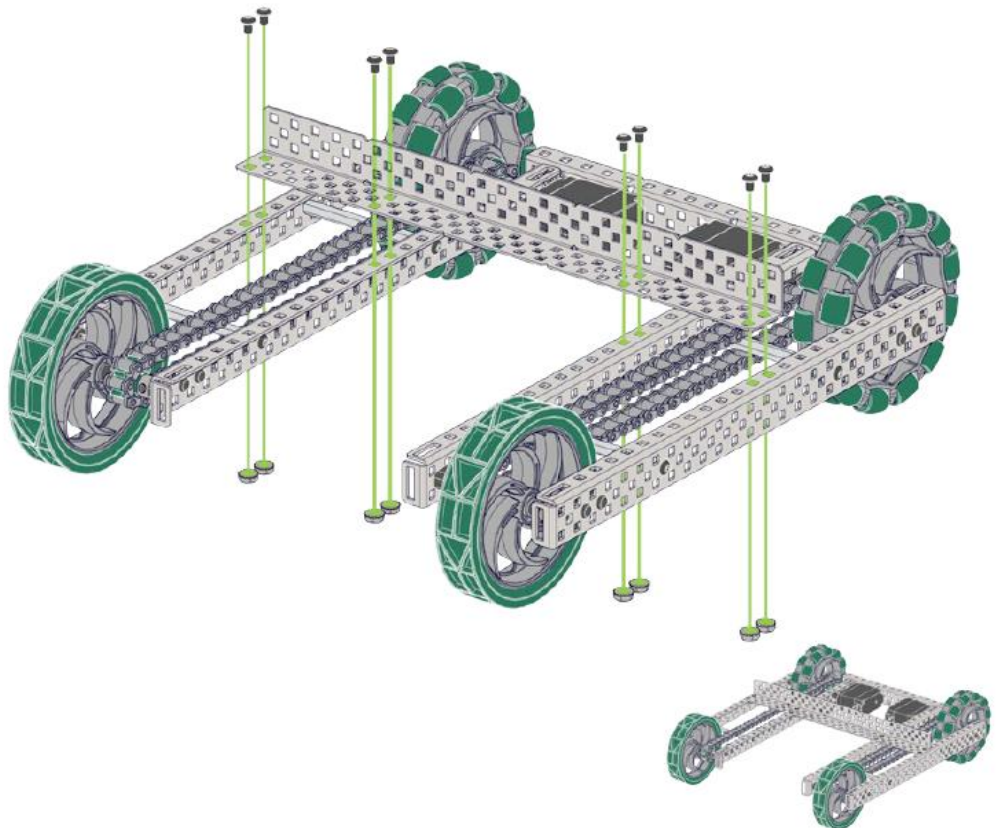



(8X)
Screw 8-32 x 0.250"



(8X)
Nut 8-32 Keps



(1X)
Angle 2x2x25

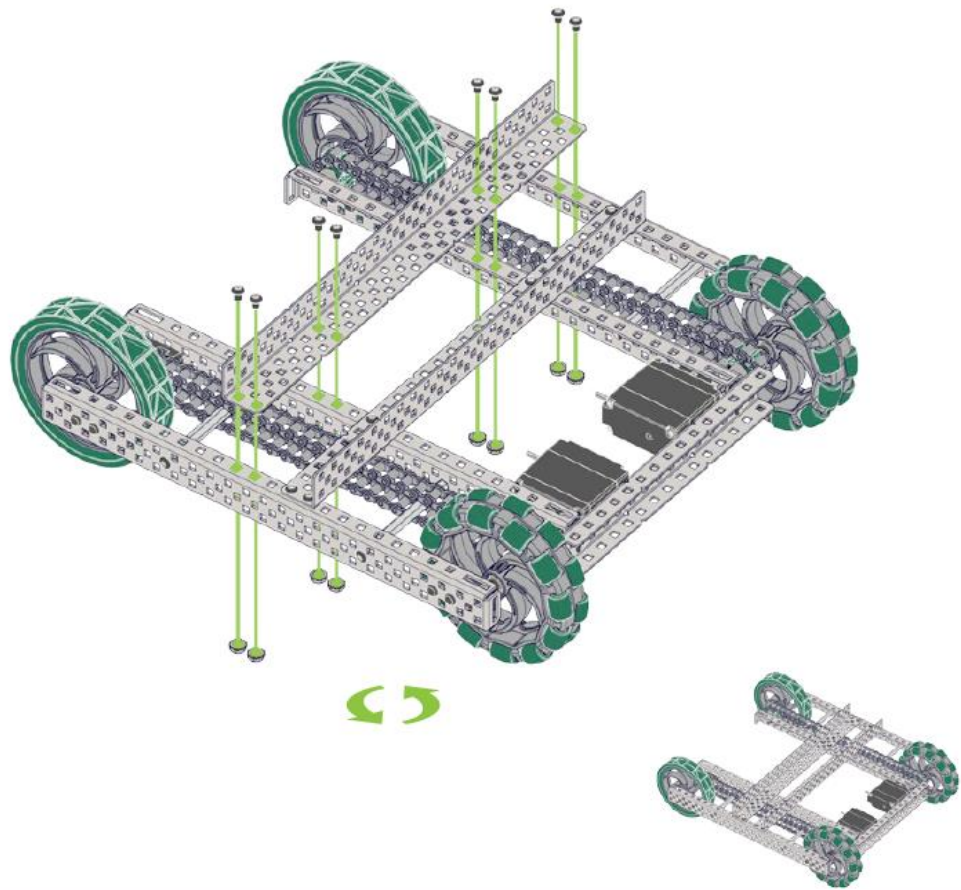
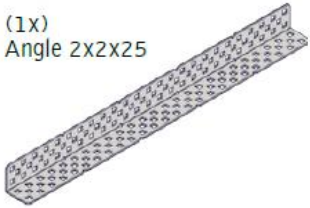

(4X)
Screw 8-32 x 0.250"



(4X)
Nut 8-32 Keps



(2X)
Linear Slide Bracket

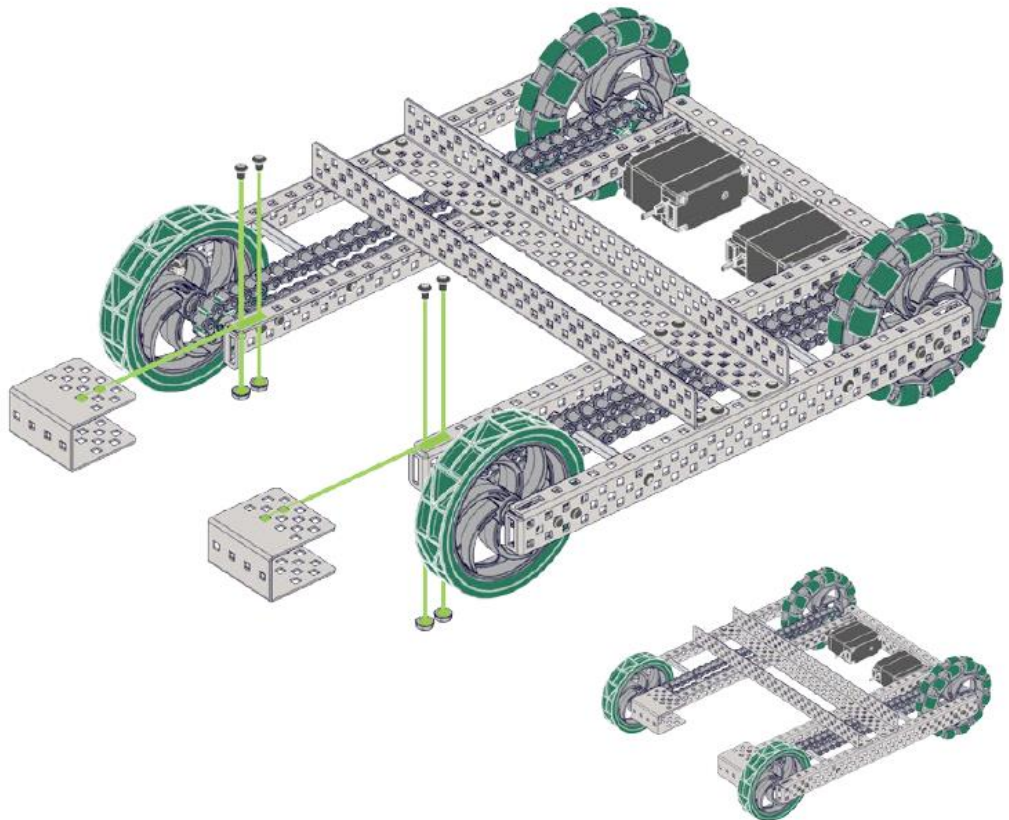
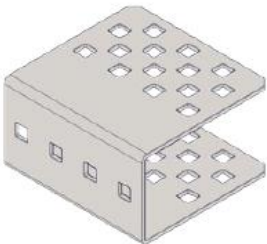



(3X)
Nut 8-32 Keps



(6X)
Plastic Spacer, 8mm



(3X)
Line Tracker

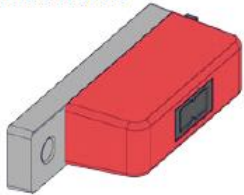

(3X)
Screw 8-32 x 1.500"

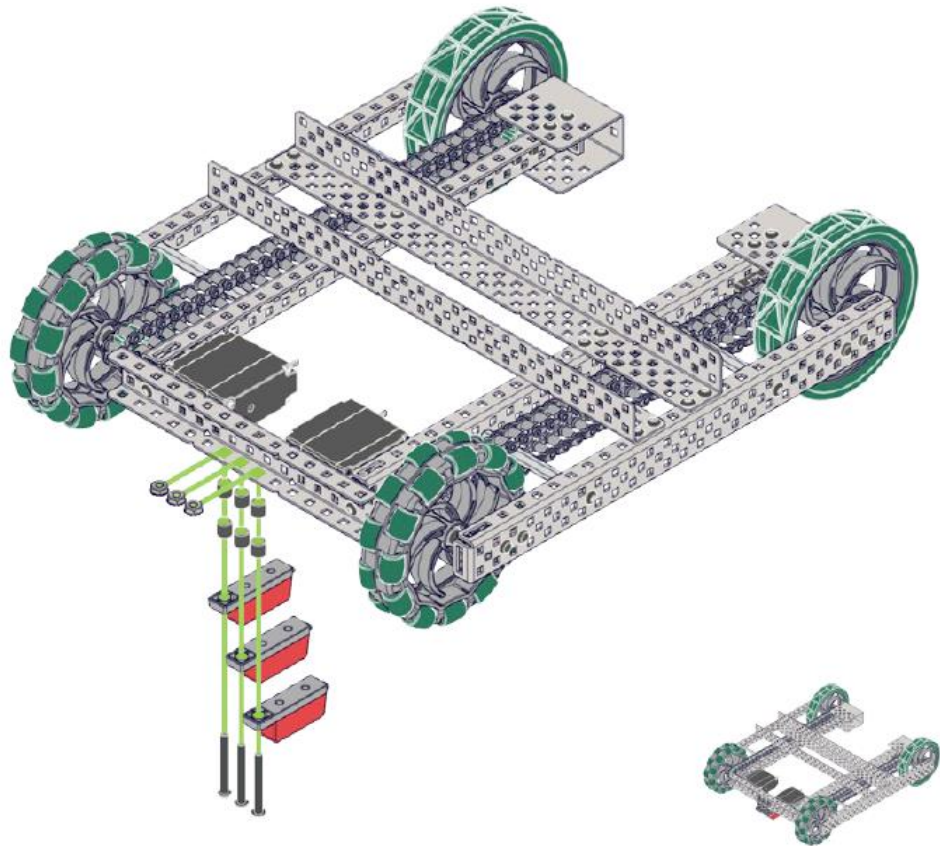

(2X)
Screw 8-32 x 0.500"



(2X)
Nut 8-32 Keps



(1X)
Bumper Switch

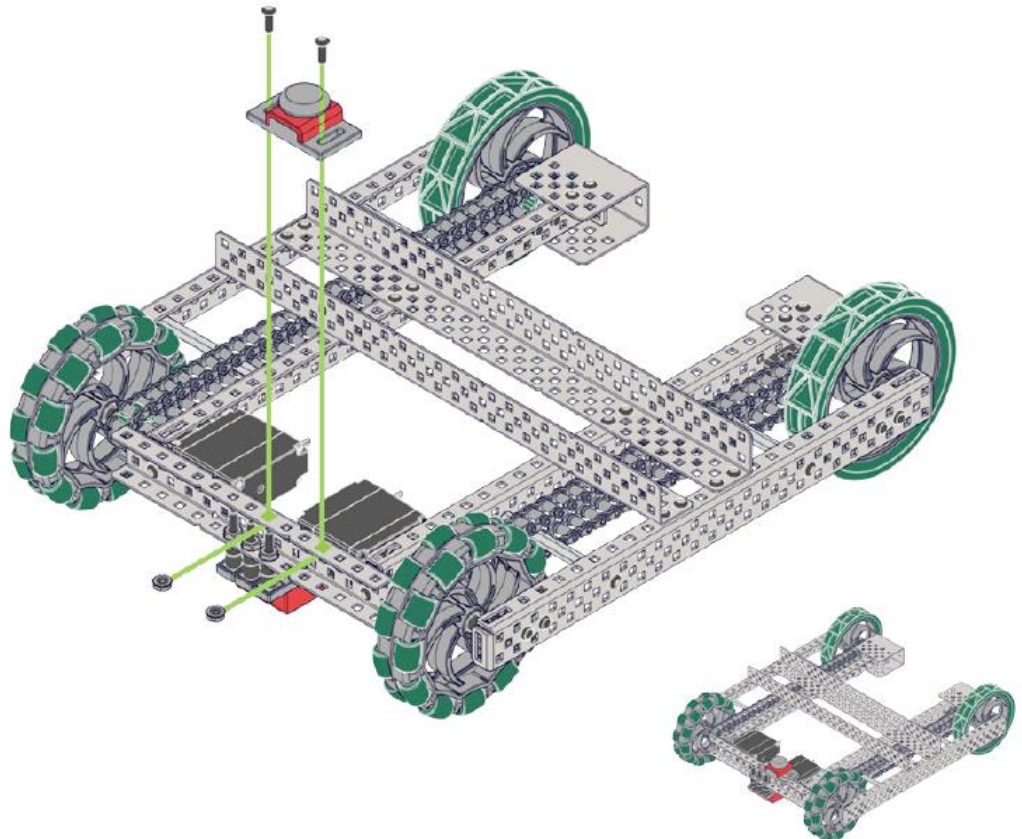
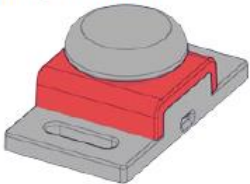



(4x)
Screw 6-32 x 0.500" Silver



(2x)
Bearing Flat



(1x)
C-Channel 1X5X1X25



(2x)
2-Wire Motor 393



(1x)
1/8" Shaft Coupler



(1x)
0.5" Shaft

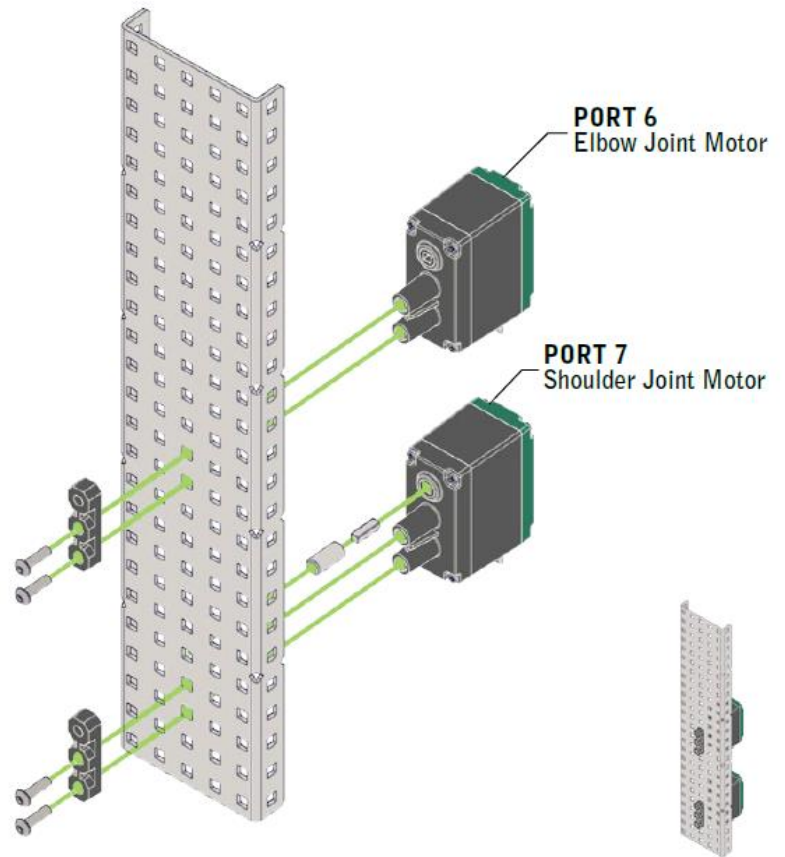

(2x)
Screw 8-32 x 0.750"



(2x)
Teflon Washer



(4x)
Plastic Spacer, 4.6mm



(2x)
Standoff 2.00" 1:1

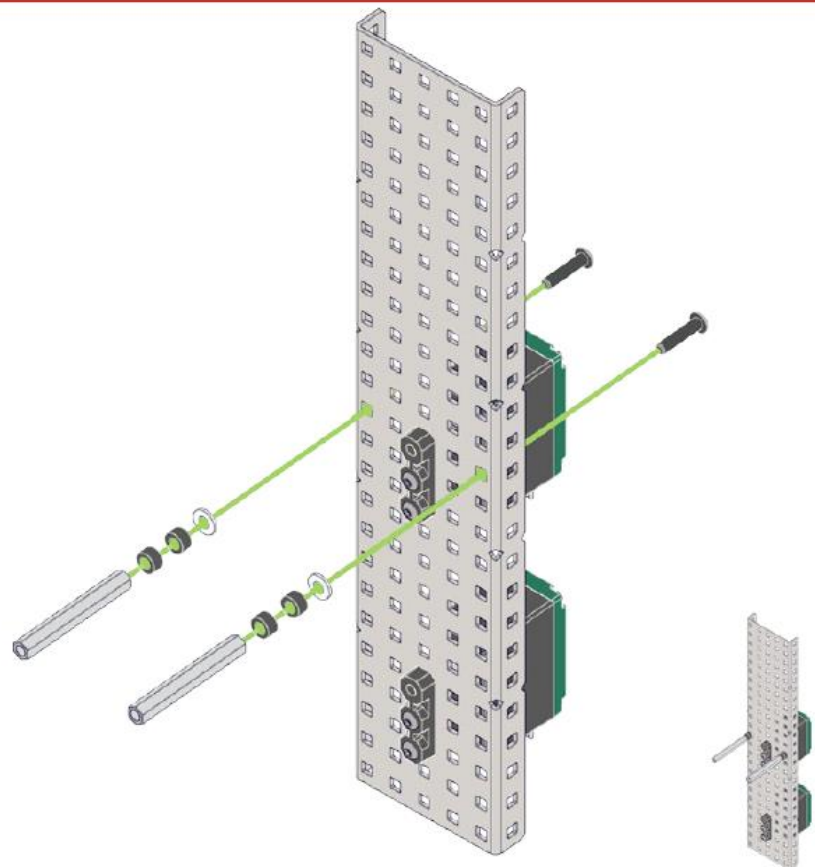
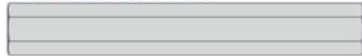



(8x)
Screw 8-32 x 0.500"



(4x)
Nut 8-32 Keps



(4x)
Nut 8-32 Nylock



(4x)
Bearing Flat

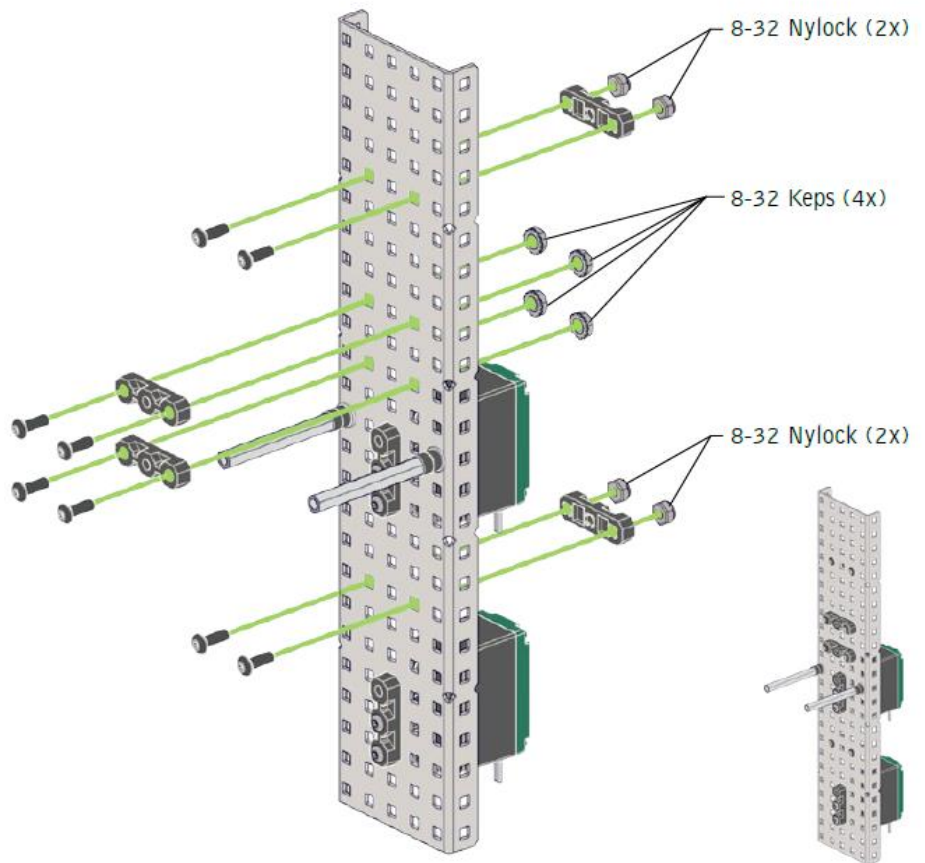

(5x)
Shaft Collar



(1x)
60T Gear



(1x)
Metal 12-Tooth Pinion



(1x)
High Strength 12T Sprocket

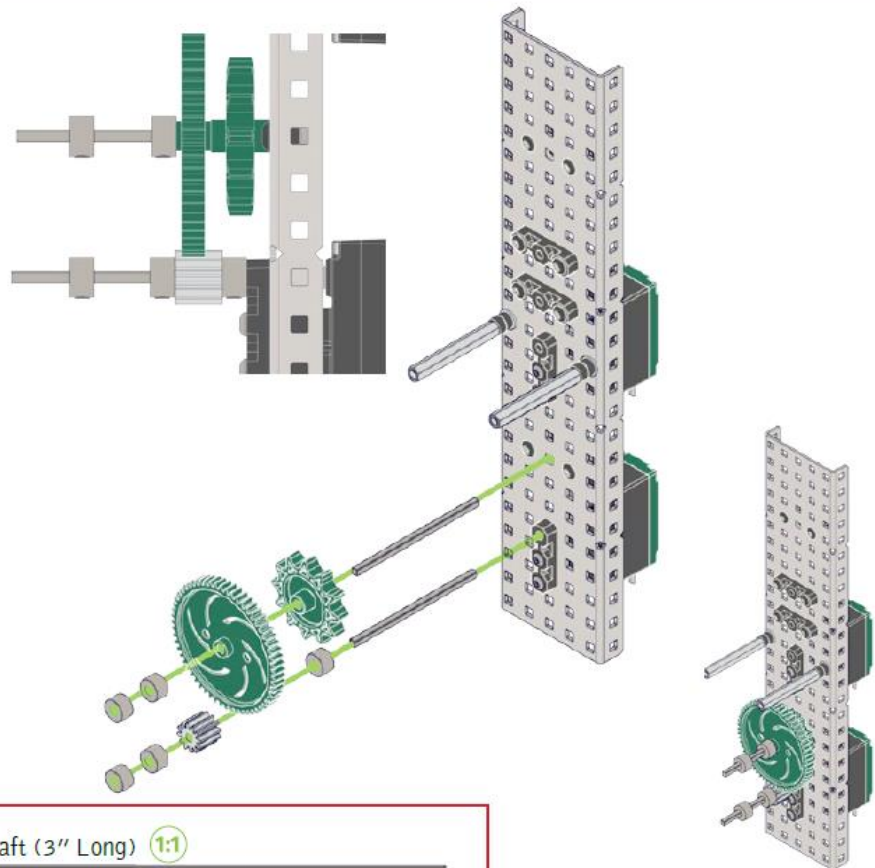



(4x) Shaft Collar



(1x) 36T Gear



(3x) Plastic Spacer, 4.6mm



(3x) Plastic Spacer, 8mm



(2x) Metal 12-Tooth Pinion



(1x) Drive Shaft (3" Long) 1:1



(1x) Drive Shaft (4" Long) 1:1

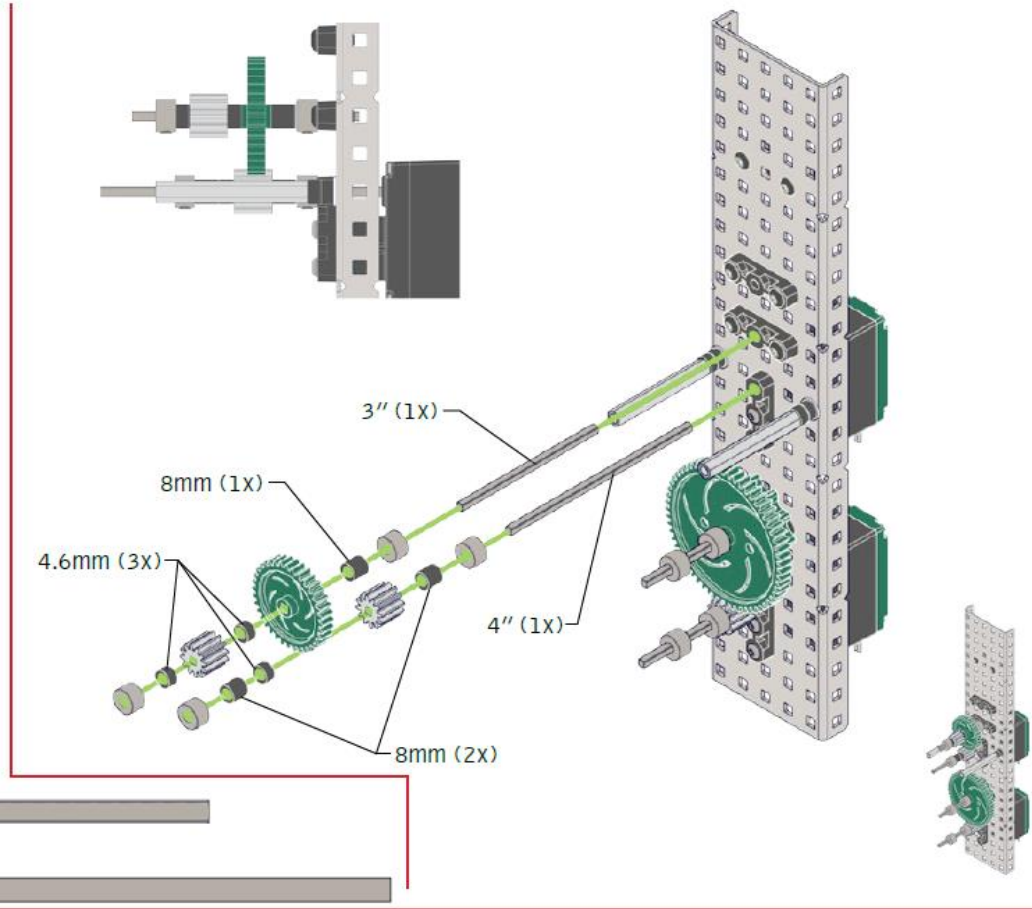

(3x) Shaft Collar



(1x) Plastic Spacer, 4.6mm



(1x) 36T High Strength Gear



(2x) Metal Gear Insert



(1x) Drive Shaft (3" Long) 1:1

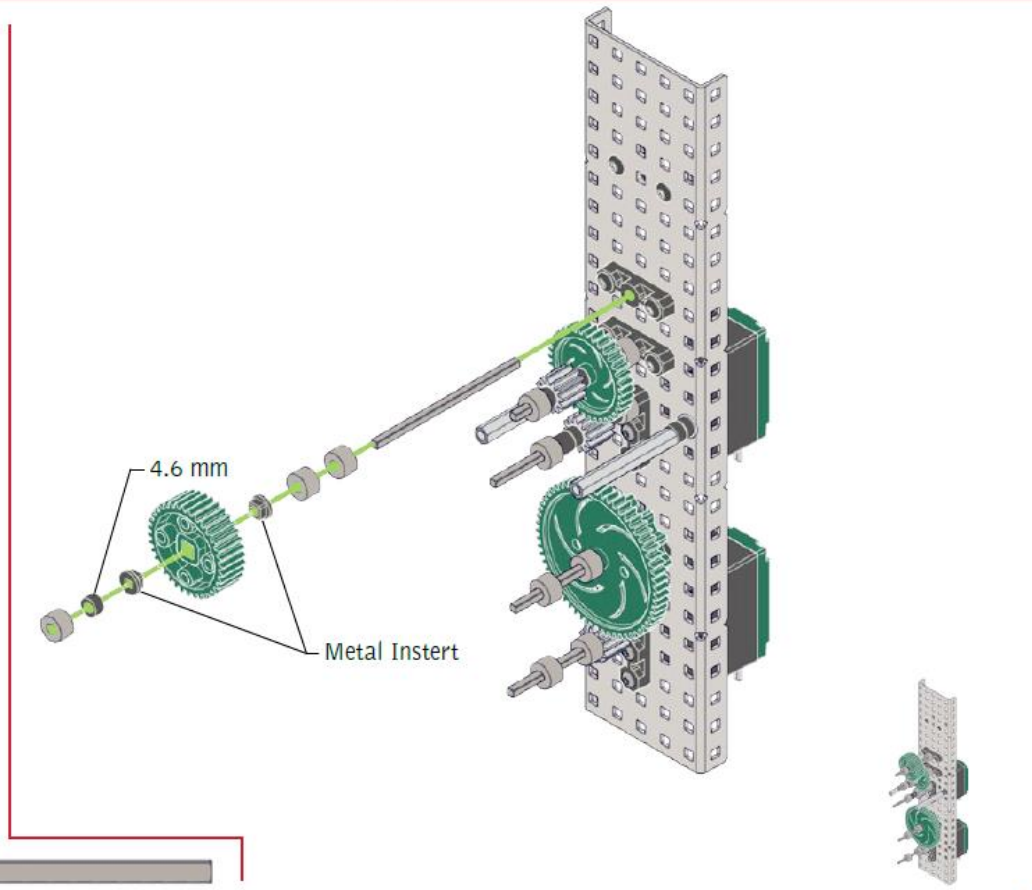
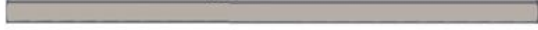



(1X) Linear Slide Track 12"

(1X) Screw 8-32 x 0.250"



(2X) Screw 8-32 x 0.500"



(2X) Screw 8-32 x 0.375"



(1X) Standoff 0.50"



(4X) Nut 8-32 Keps



(1X) Bearing Flat



(1X) Limit Switch

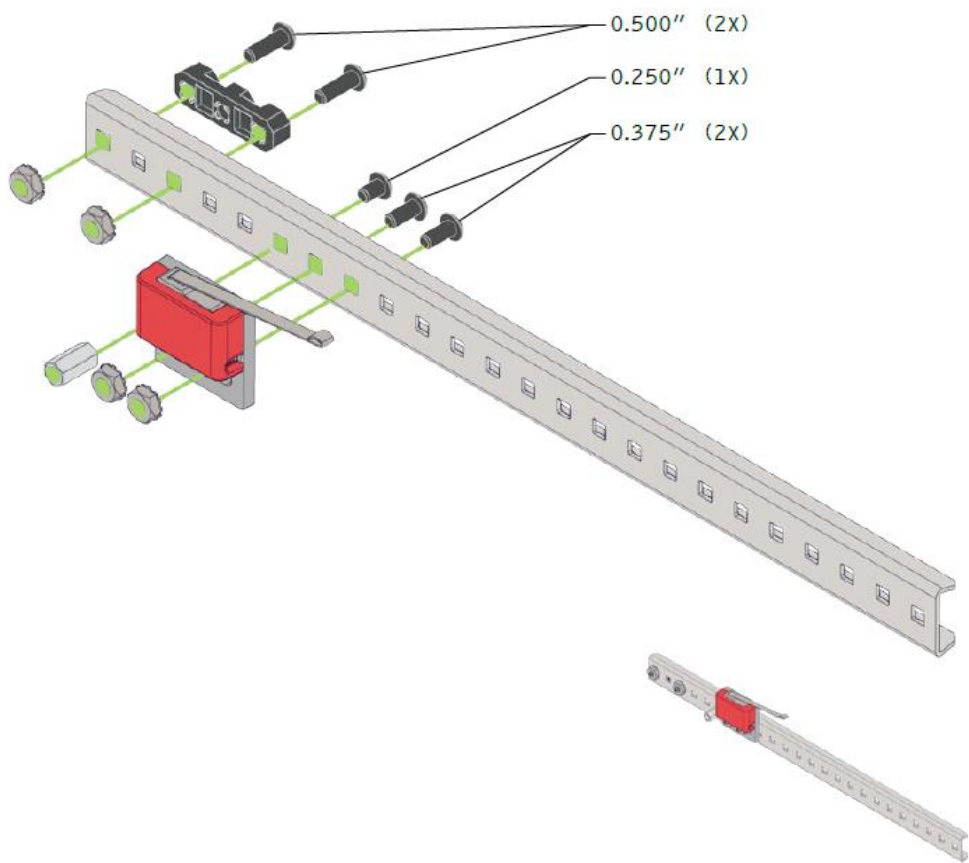

(2X) Plastic Spacer, 4.6mm

(1X) Screw 8-32 x 0.250"



(2X) Round Gear Insert

(2X) Screw 8-32 x 0.500"



(2X) Screw 8-32 x 0.750"



(1X) 60T High Strength Gear

(4X) Nut 8-32 Keps



(1X) Bearing Flat



(1X) Linear Slide Track 12"

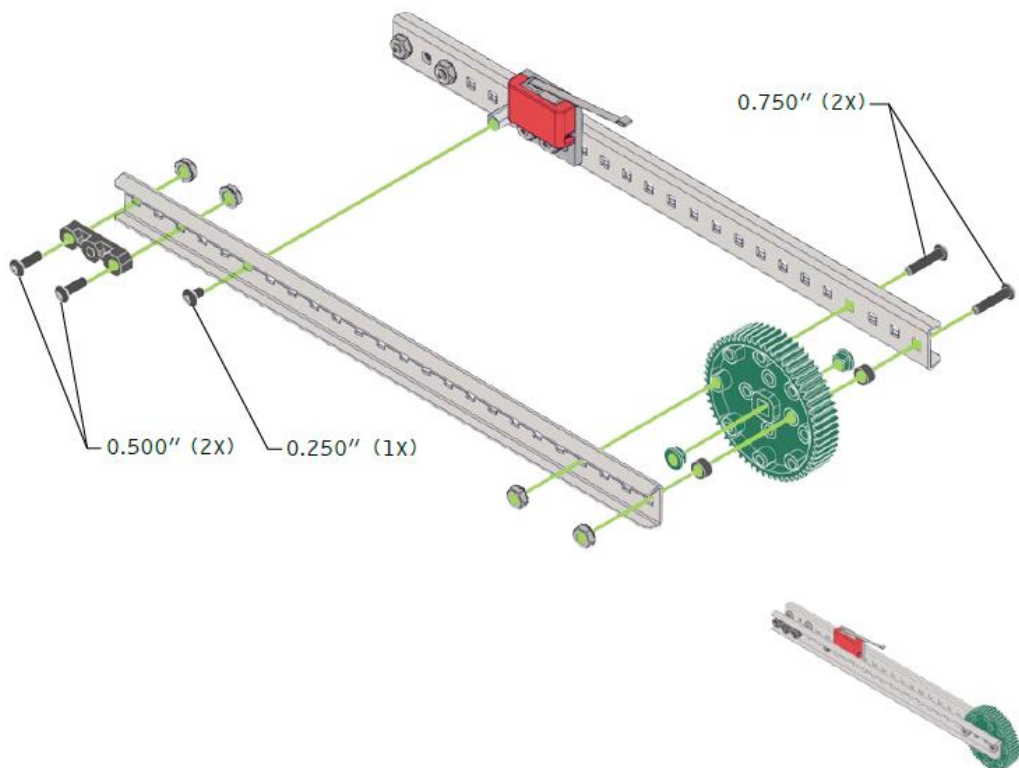



(2X) Standoff 0.50" 1:1

(1X) High Strength 18T Sprocket



(3X) Teflon Washer



(4X) Screw 8-32 x 0.250"



(1X) Shaft Collar



(1X) Plastic Spacer, 4.6mm



(1X) High Strength 24T Sprocket



(1X) Drive Shaft (3" Long) 1:1

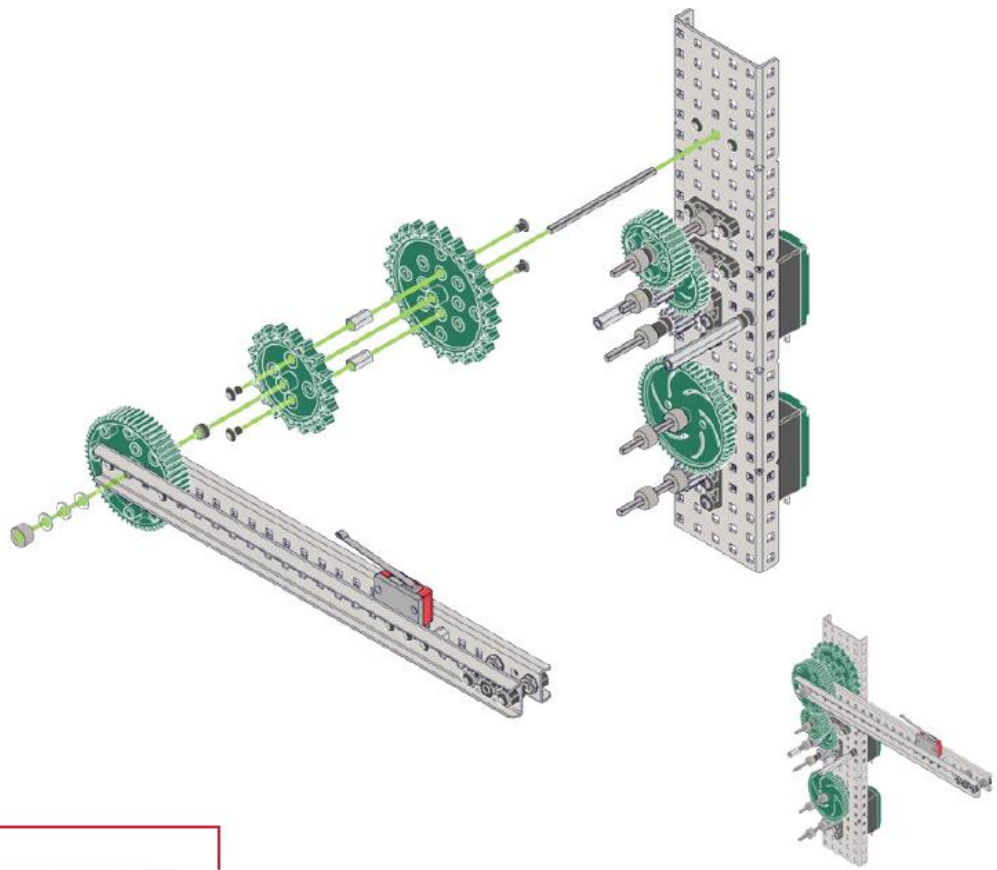

(6X) Screw 8-32 x 0.500"



(6X) Nut 8-32 Nylock



(1X) C-Channel 1x5x1x25



(3X) Bearing Flat

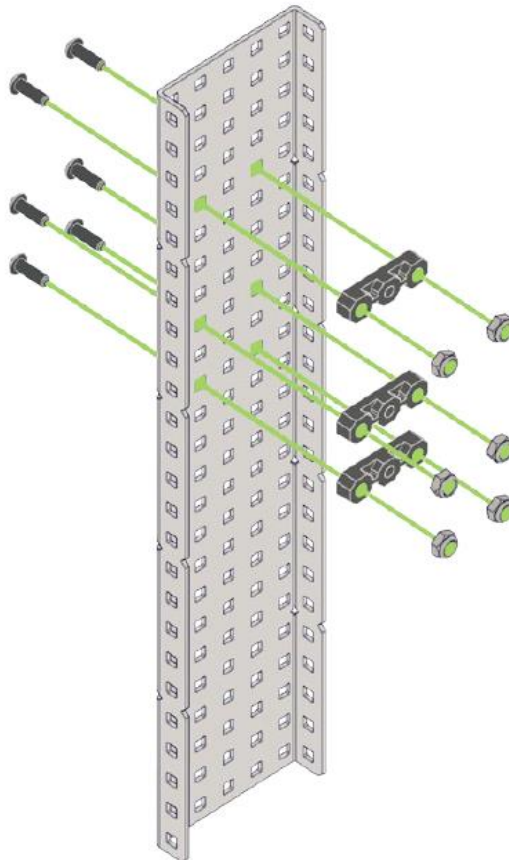



(2X)
Screw 8-32 x 0.500"



(2X)
Nut 8-32 Keps



(3X)
Bearing Flat



(4X)
Outer Rivet



(4X)
Inner Rivet

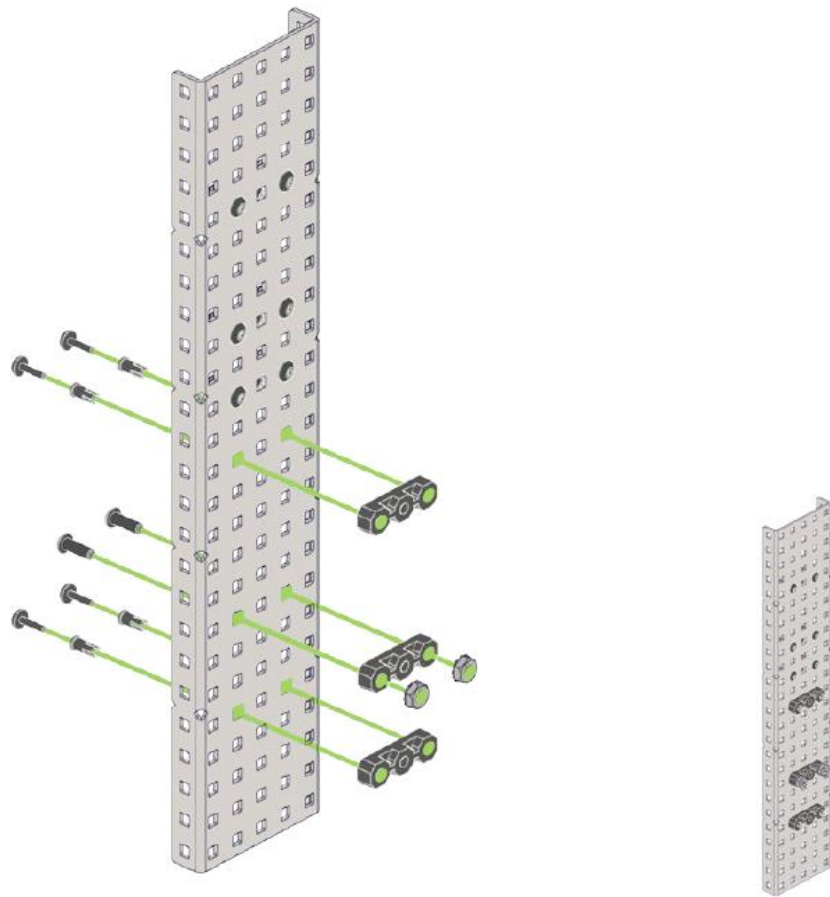

(6X)
Screw 8-32 x 0.375"



(4X)
Screw 8-32 x 0.250"



(2X)
Optical Shaft Encoder



(1X)
Limit
Switch

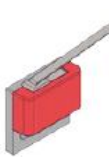

(2X)
1/8" Shaft Coupler



(2X)
Nut 8-32 Keps



(4X)
Standoff 1.00" 1:1

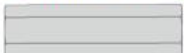

(2X)
Drive Shaft (2" Long) 1:1



0.375" (4x)

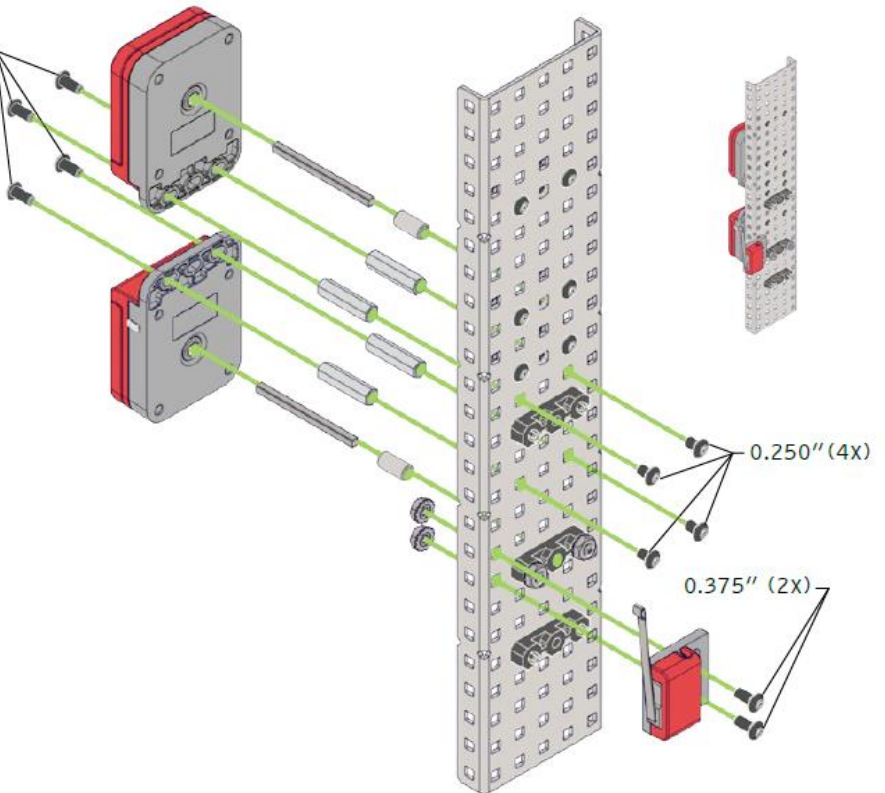

0.250" (4x)

0.375" (2x)



(2x)
Screw 8-32 x 0.250"



(1x)
Shaft Collar

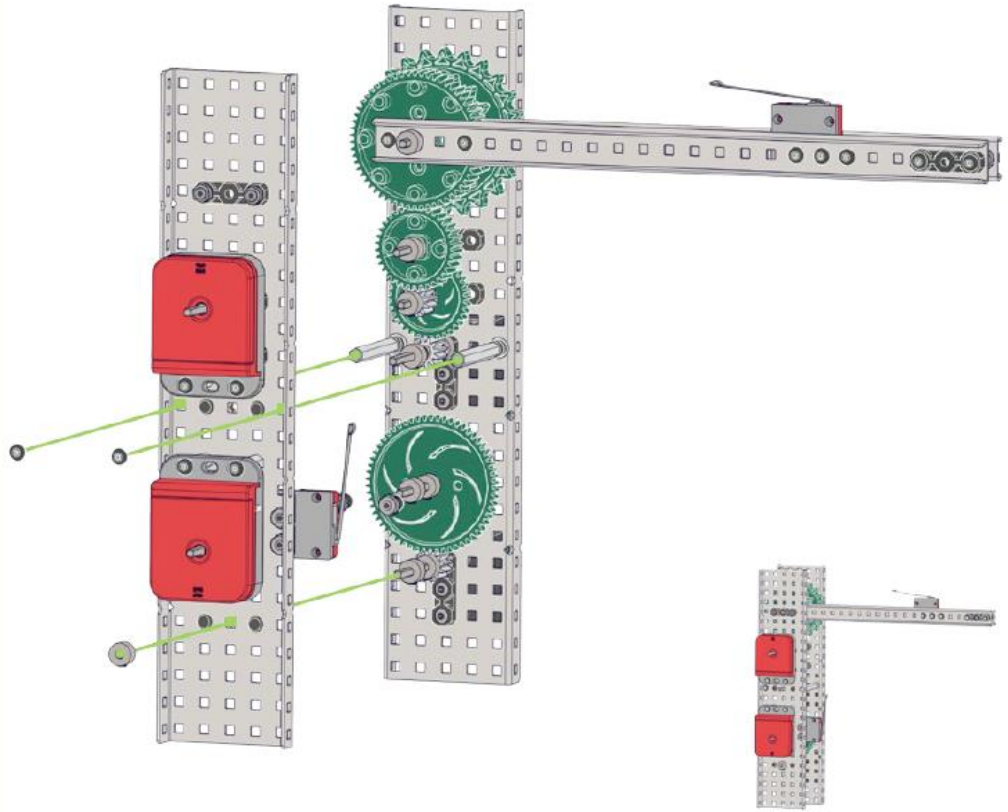

(65x)
High Strength Chain Link

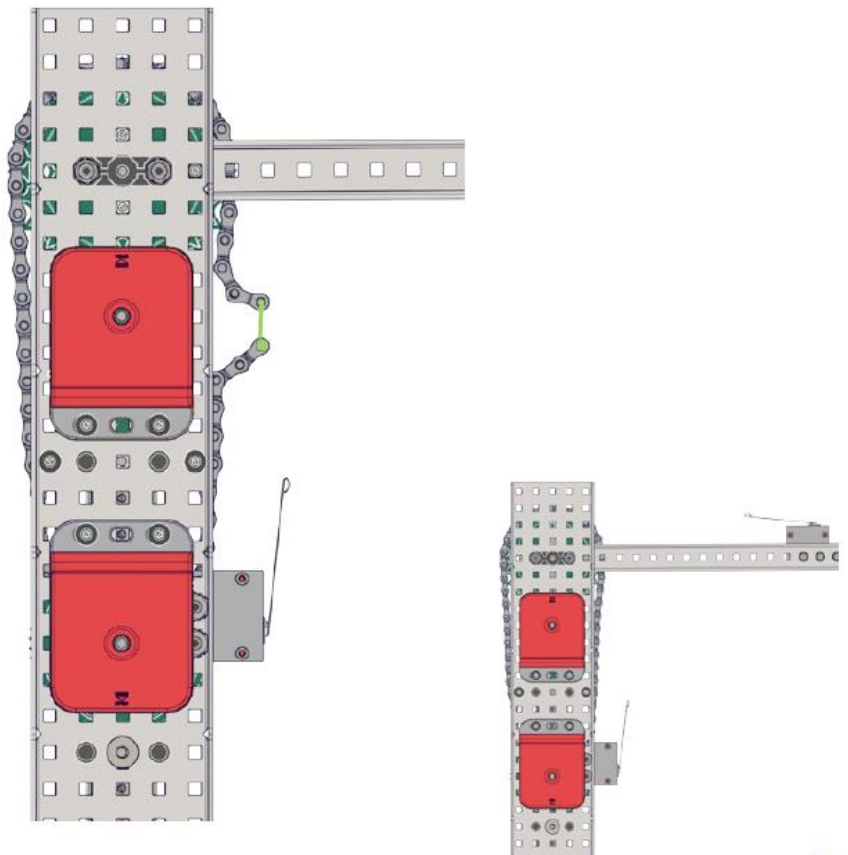
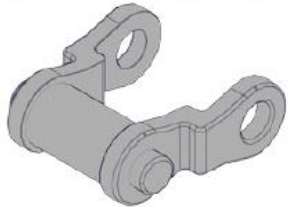



(6X)
Screw 8-32 X 0.250"



(6X)
Nut 8-32 Keps

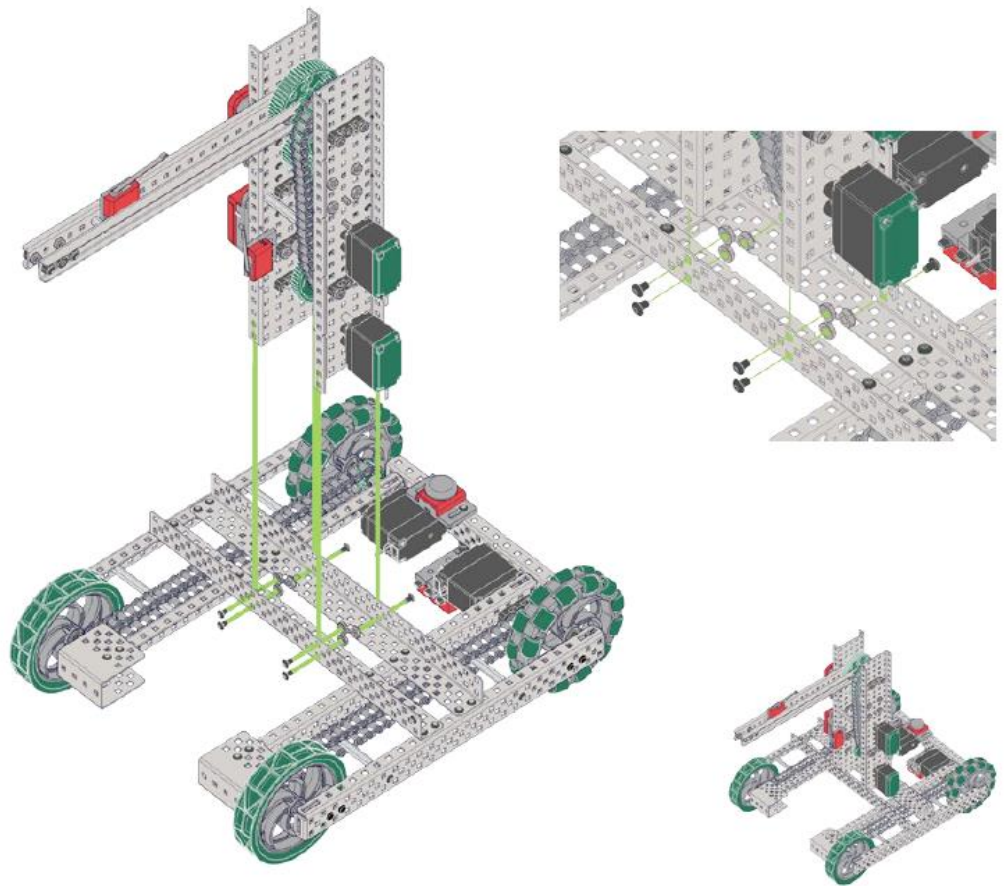

(4X)
Screw 8-32 X 0.250"



(4X)
Nut 8-32 Keps



(2X)
2X1X16 Chassis Rail

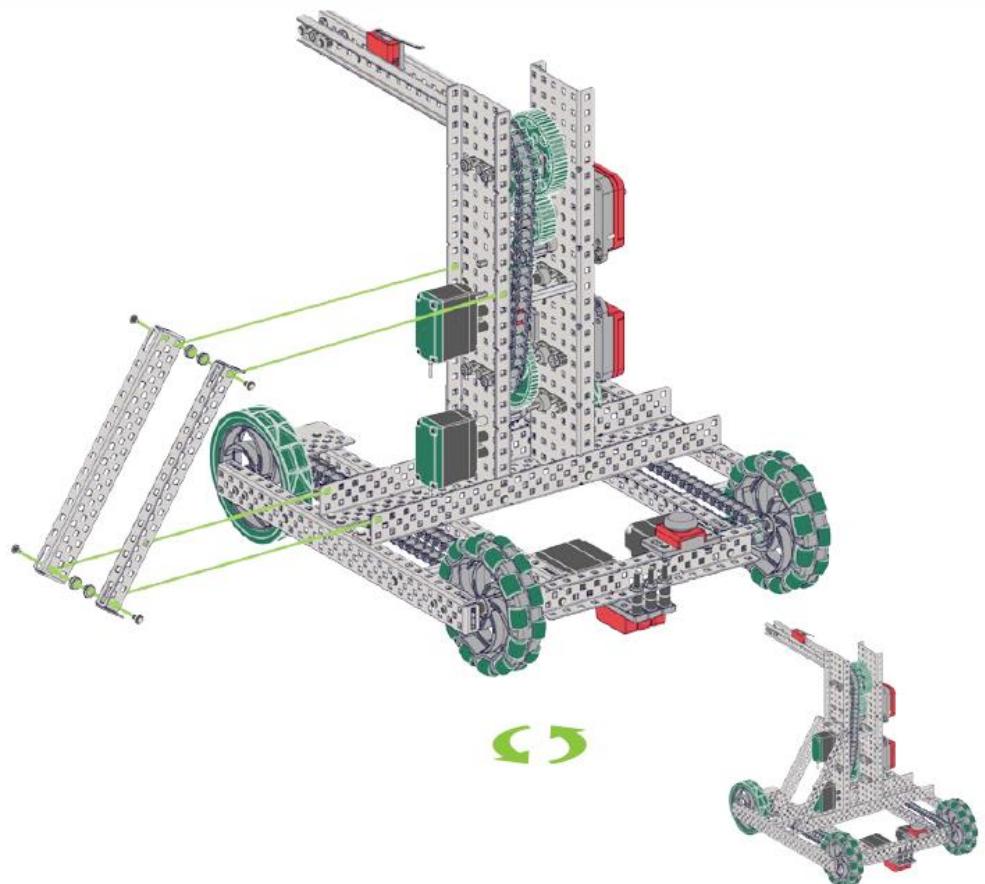

33

(4x)
Screw 8-32 x 0.250"



(4x)
Nut 8-32 Keps



(2x)
15X16 Chassis Rail

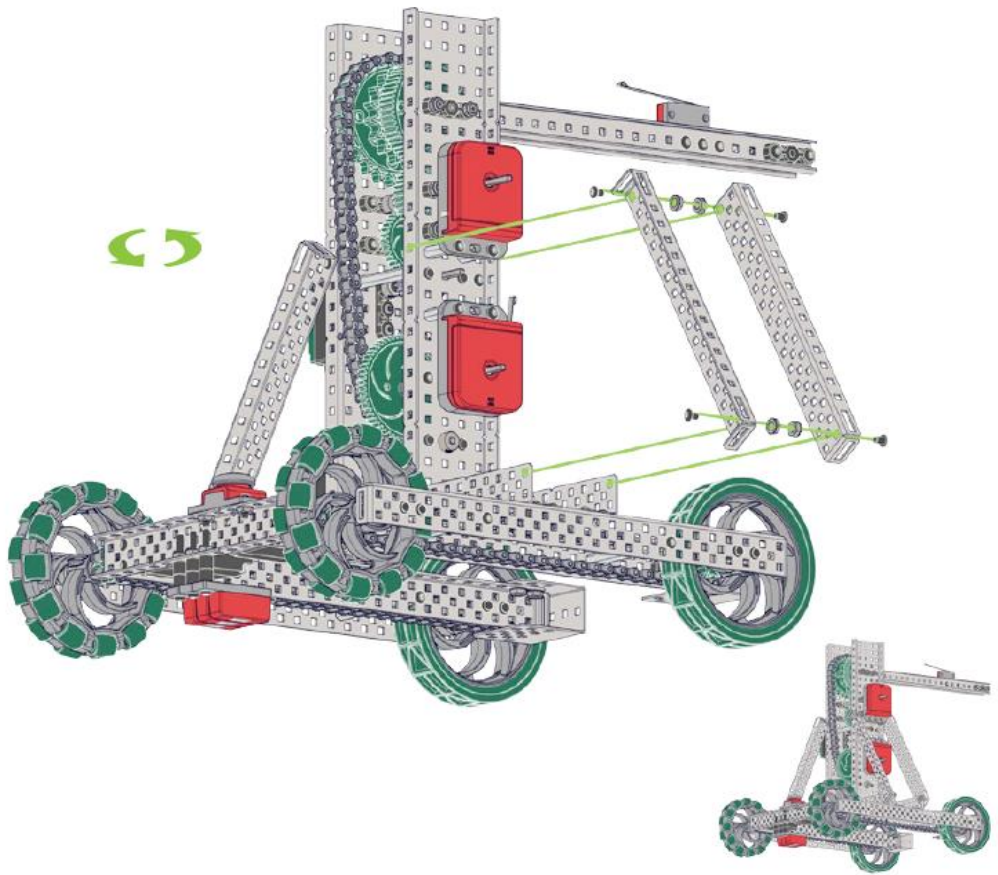

34

(1x)
VEX Arm Cortex
Microcontroller

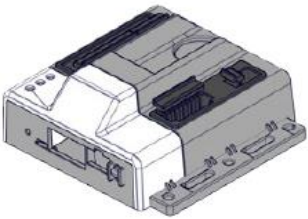

(1x)
VEXnet Key 2.0



(4x)
4" Zip Tie

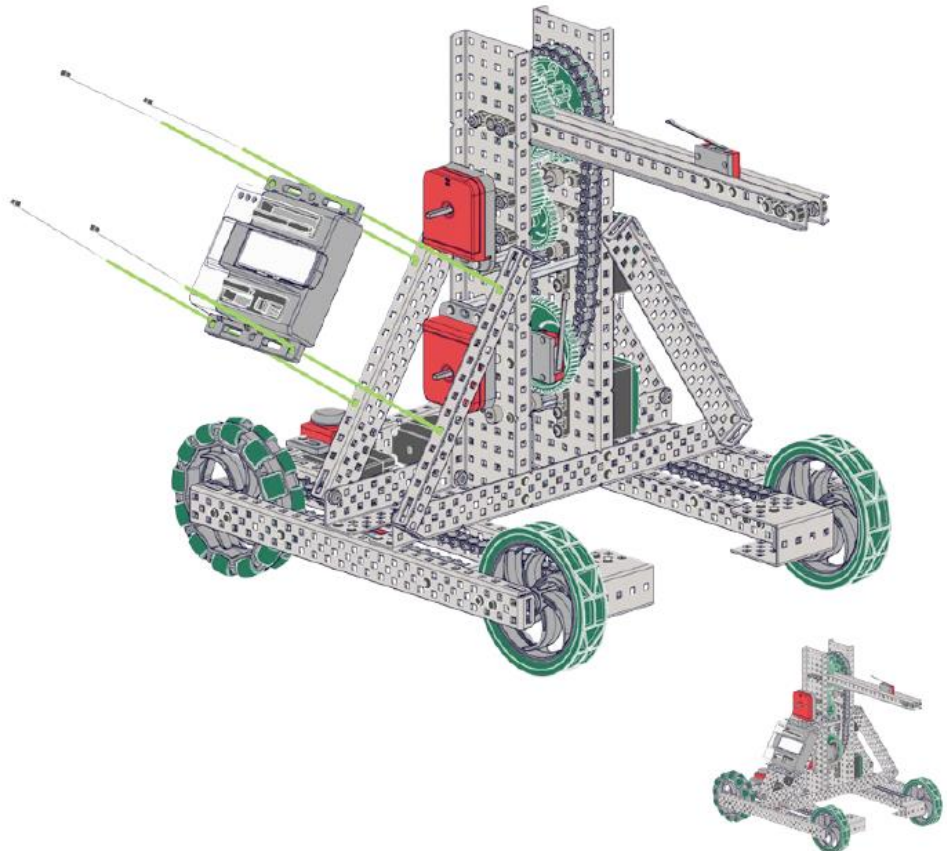

35

(2X)
Screw 8-32 x 0.750"



(2X)
Nut 8-32 Nylock



(1X)
Plus Gusset



(1X)
60T High Strength Gear

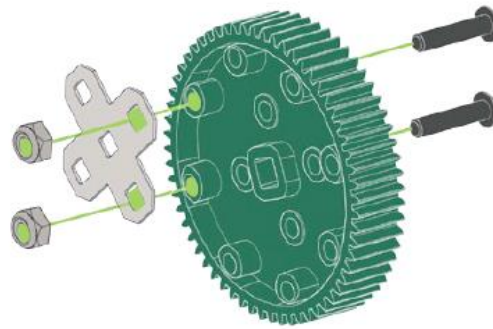

36

(4X)
Screw 8-32 x 0.750"



(4X)
Nut 8-32 Nylock



(2X)
Angle Gusset

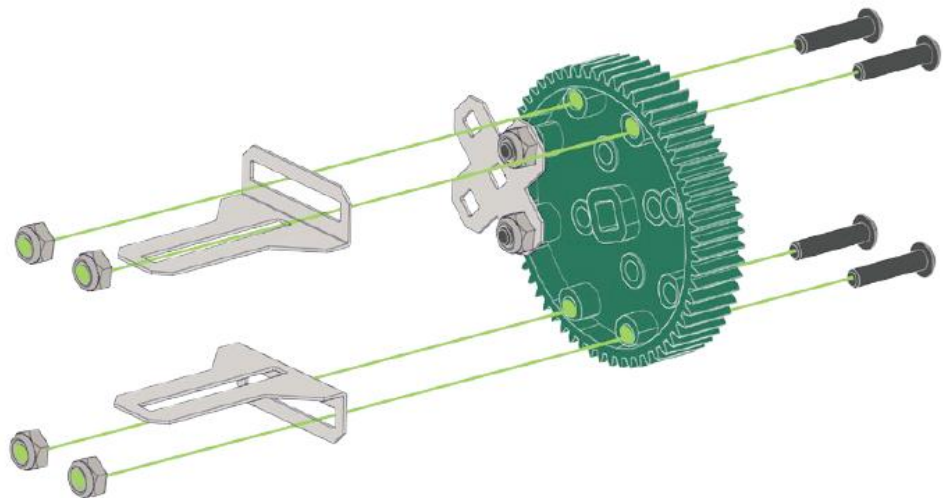



(1x)
Plate 5x5

(4x)
Nut 8-32 Nylock



(3x)
Screw 8-32 x 0.250"



(4x)
Screw 8-32 x 0.500"



(3x)
Standoff 0.50"



(2x)
Bearing Flat

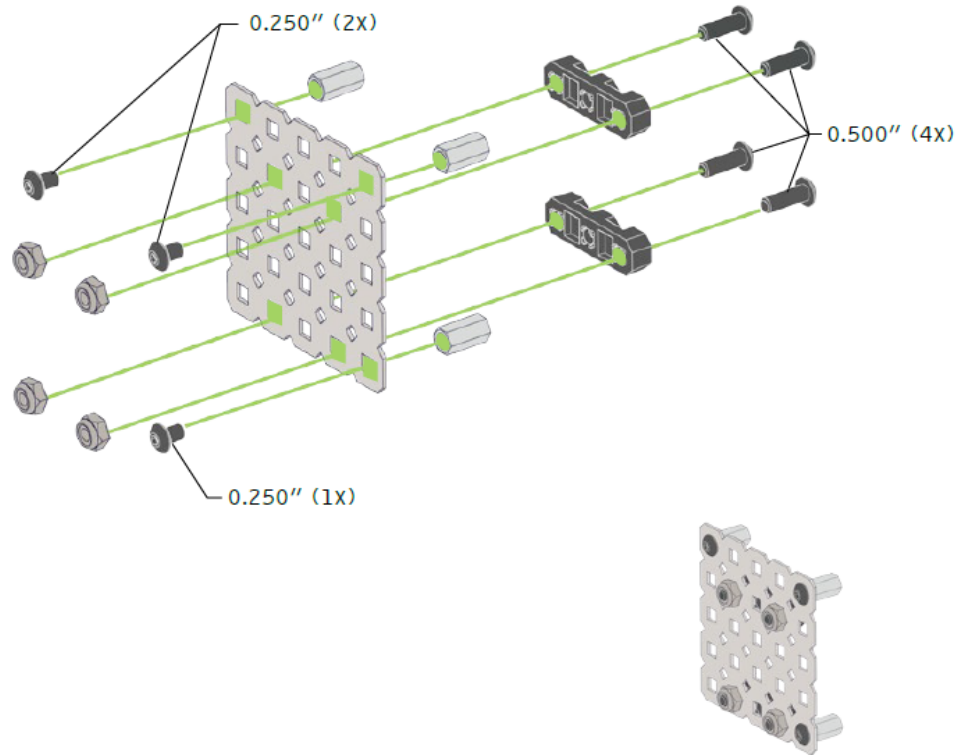

(1x)
Nut 8-32 Nylock



(2x)
Plastic Gear Insert



(1x)
Plastic Spacer, 4.6mm



(1x)
Screw 8-32 x 1.500"

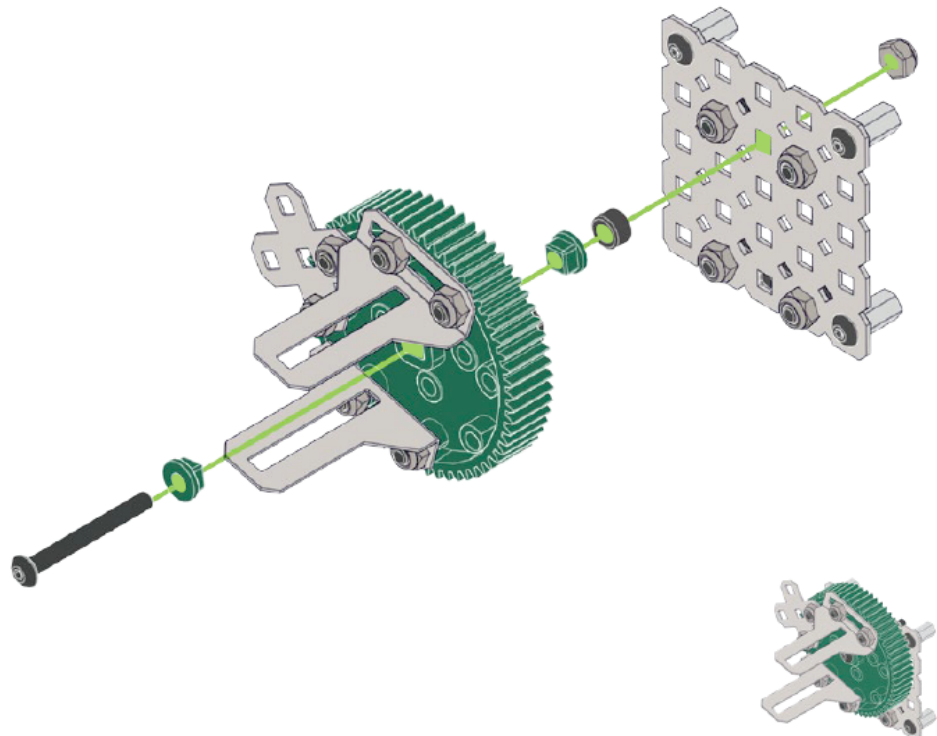

39

(1X)
Plate 5x5



(2X)
Nut 8-32 Nylock



(2X)
Screw 8-32 x 0.250"



(2X)
Angle Gusset

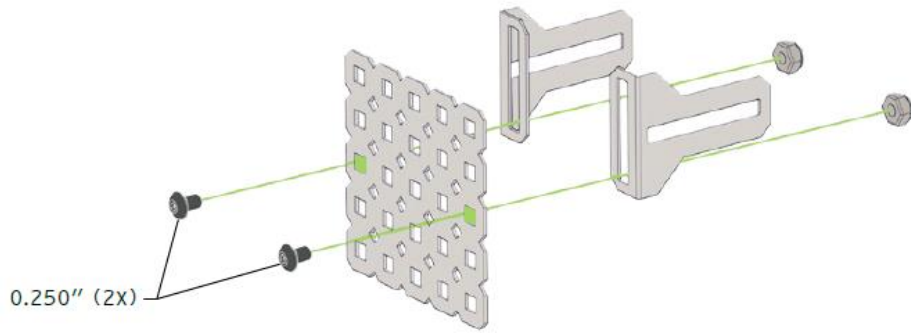

0.250" (2x)



40

(4X)
Nut 8-32 Nylock



(4X)
Screw 8-32 x 0.500"



(2X)
Bearing Flat

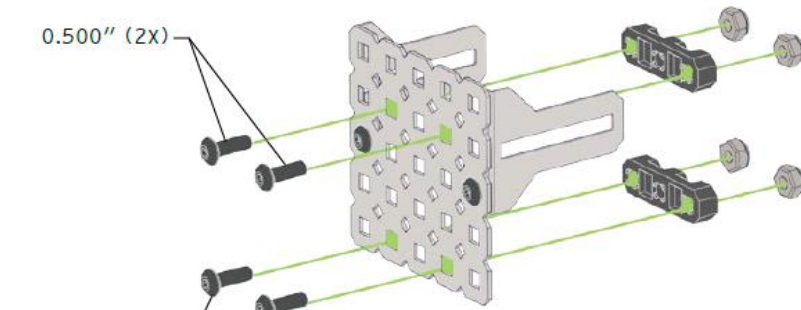

0.500" (2x)

0.500" (2x)





(1x)
2-Wire Motor 393



(1x)
Shaft Collar



(2x)
Screw 6-32 x 0.250" Silver



(1x)
Drive Shaft (3" Long) 1:1



PORT 8
Wrist Joint Motor

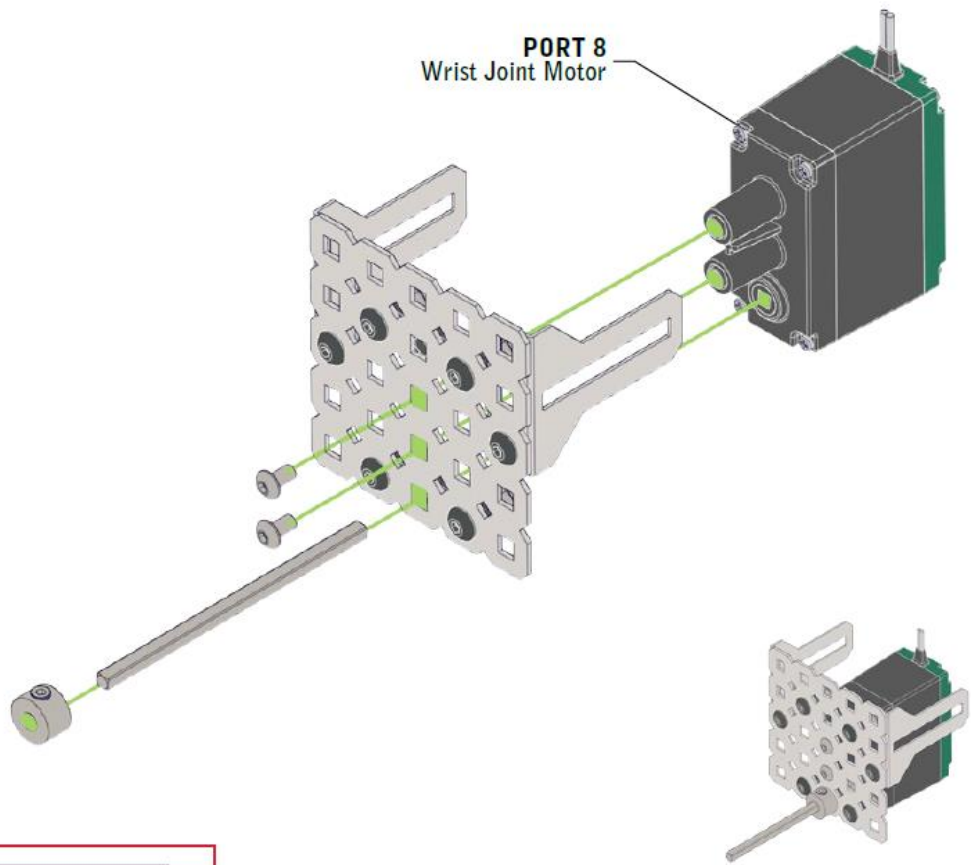

(3x)
Screw 8-32 x 0.250"



(1x)
Shaft Collar



(1x)
Plastic Spacer, 4.6mm



(1x)
Metal 12T Pinion

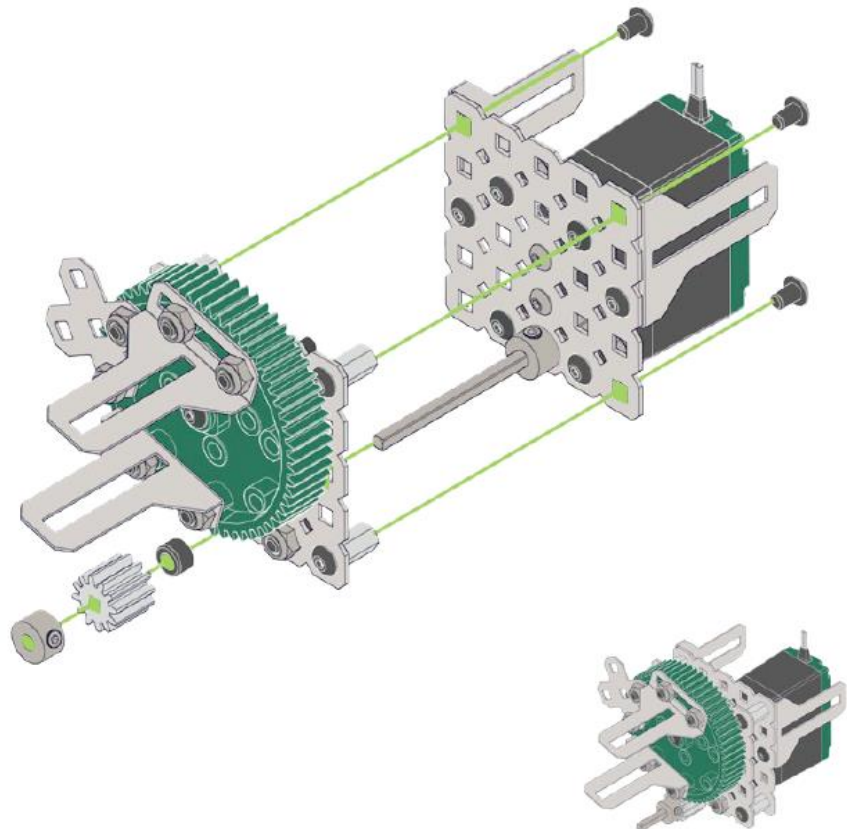



(2X)
Screw 8-32 x 0.250"



(2X)
Screw 8-32 x 0.500"



(2X)
Plastic Spacer, 4.6mm



(2X)
Nut 8-32 Nylock



(2X)
Standoff 0.50"



(1X)
C-Channel 1x2x1x15

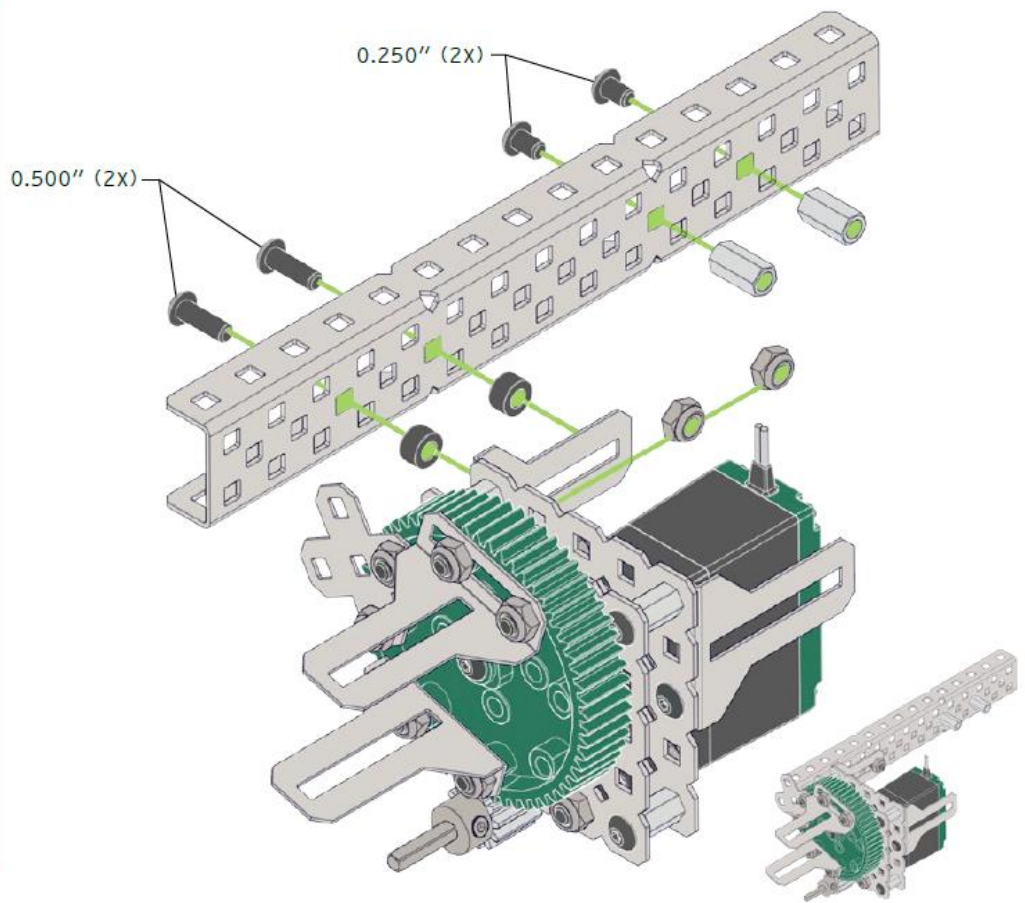

(2X)
Screw 8-32 x 0.250"



(2X)
Screw 8-32 x 0.500"



(2X)
Plastic Spacer, 4.6mm



(4X)
Nut 8-32 Nylock

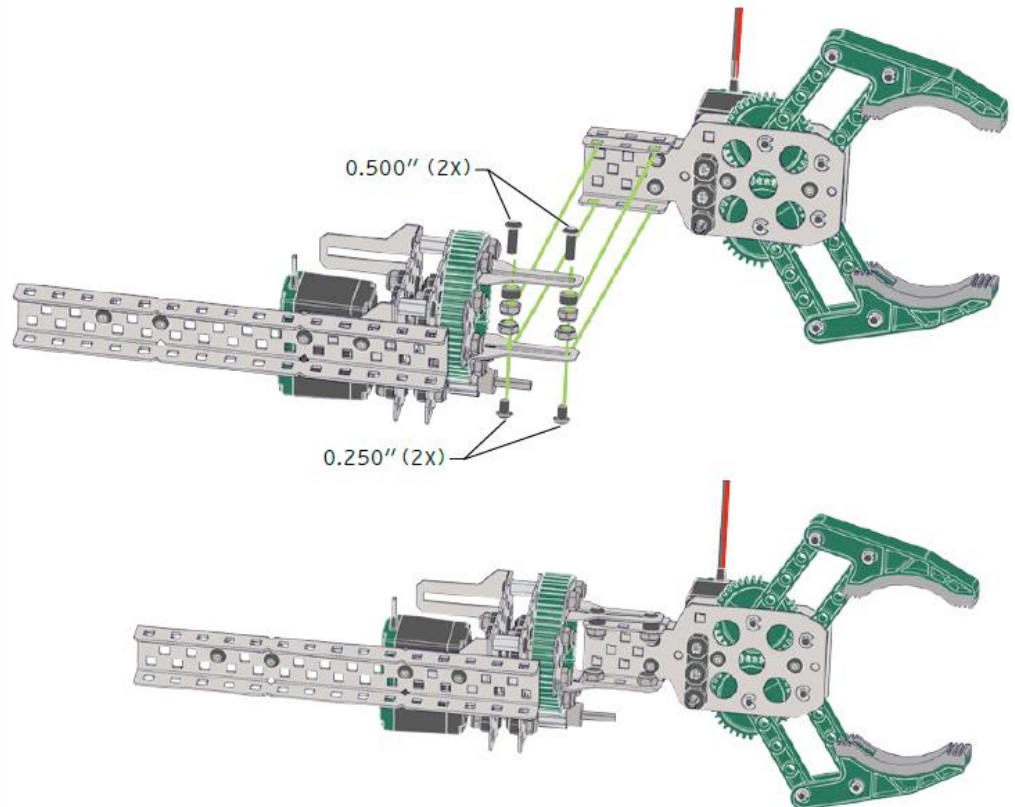

45

(4x)
Screw 8-32 x 0.250"



(2x)
45 Degree Gusset



(2x)
Standoff 2.00" 1:1

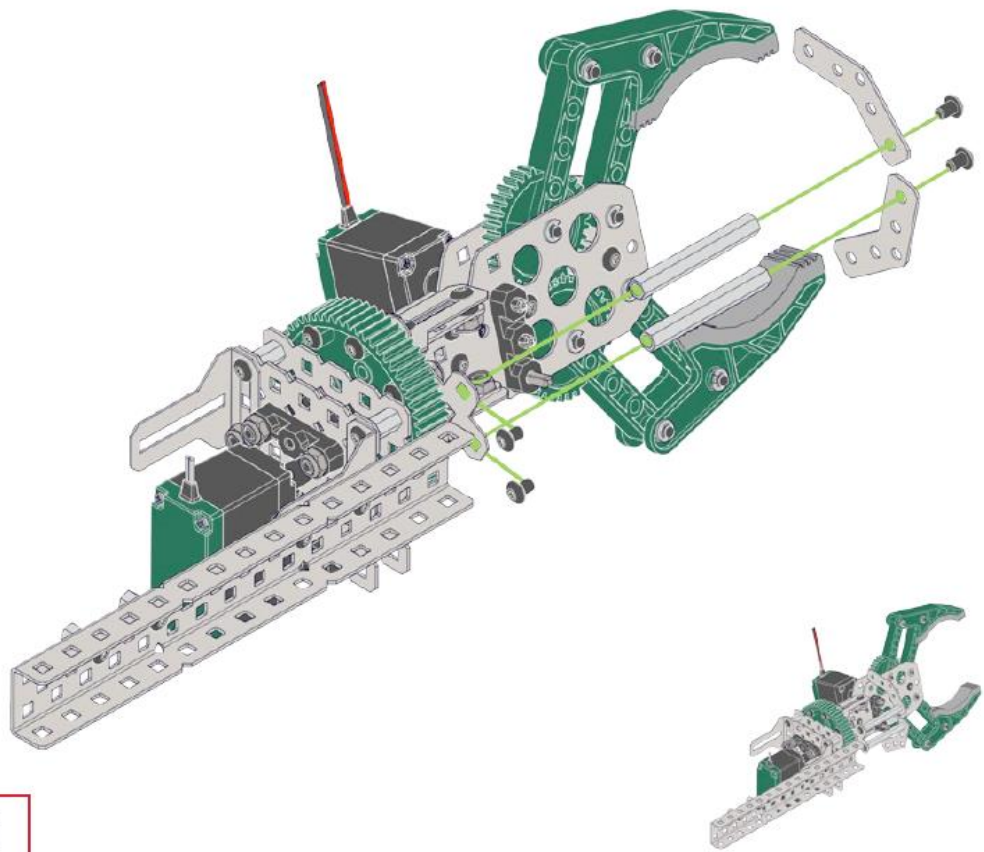
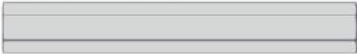

46

(2x)
Screw 8-32 x 0.375"



(2x)
Nut 8-32 Keps



(1x)
Ultrasonic Range Finder

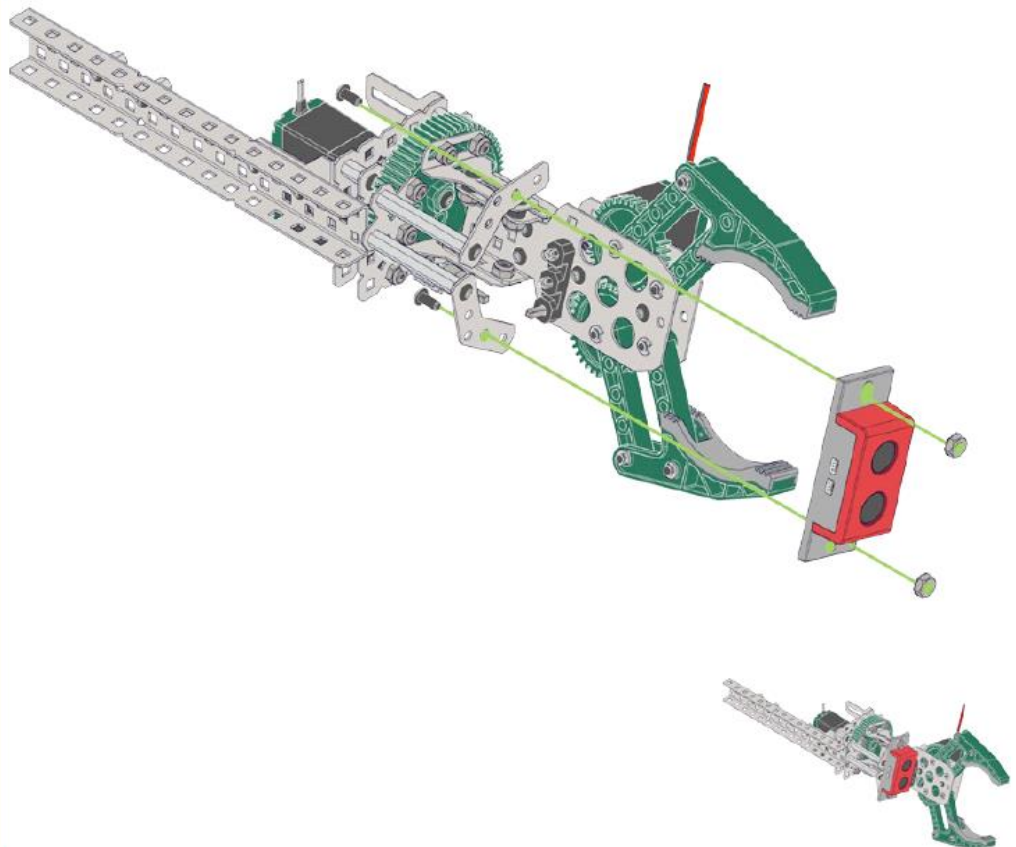



(2x)
Screw 8-32 x 0.250"



(1x)
High Strength 18T Sprocket



(2x)
Standoff 0.50" **1:1**

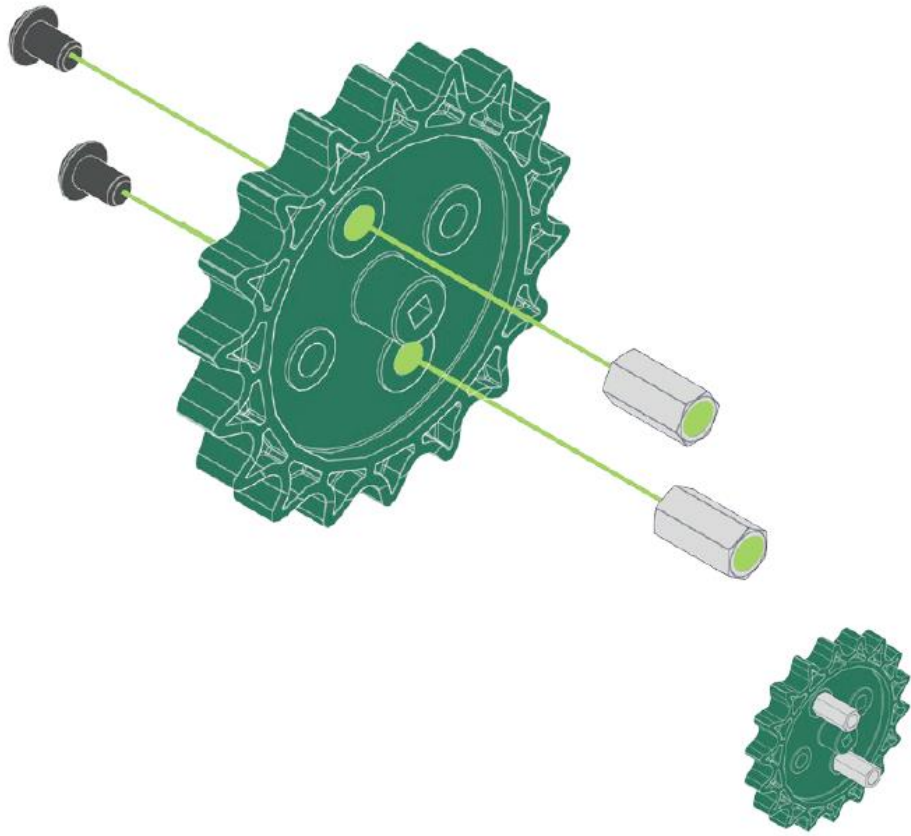

(2x)
Screw 8-32 x 0.250"



(2x)
Shaft Collar



(1x)
High Strength 24T Sprocket

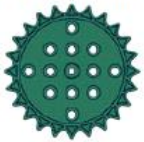

(1x)
Drive Shaft (3" Long) **1:1**

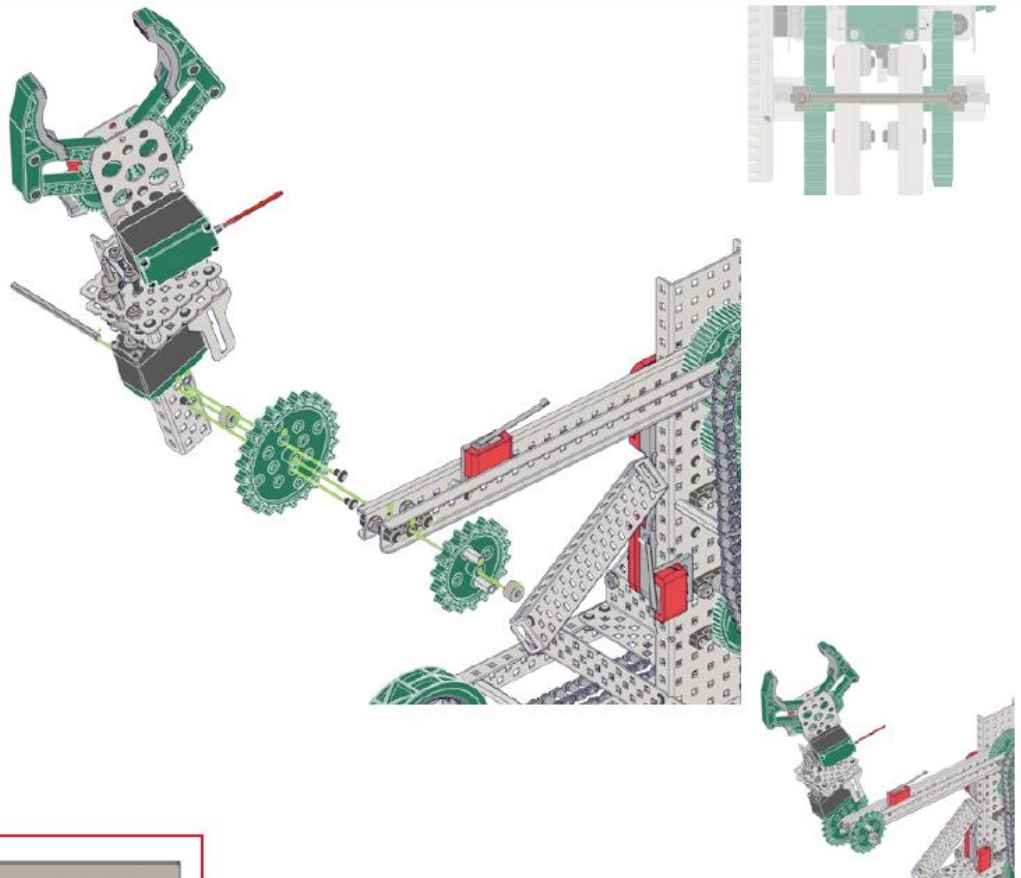
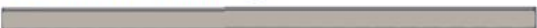

49

(2x)
Screw 8-32 x 0.250"



(2x)
Screw 8-32 x 0.500"



(6x)
Teflon Washer



(2x)
Nut 8-32 Nylock



(1x)
C-Channel 1x2x1x15

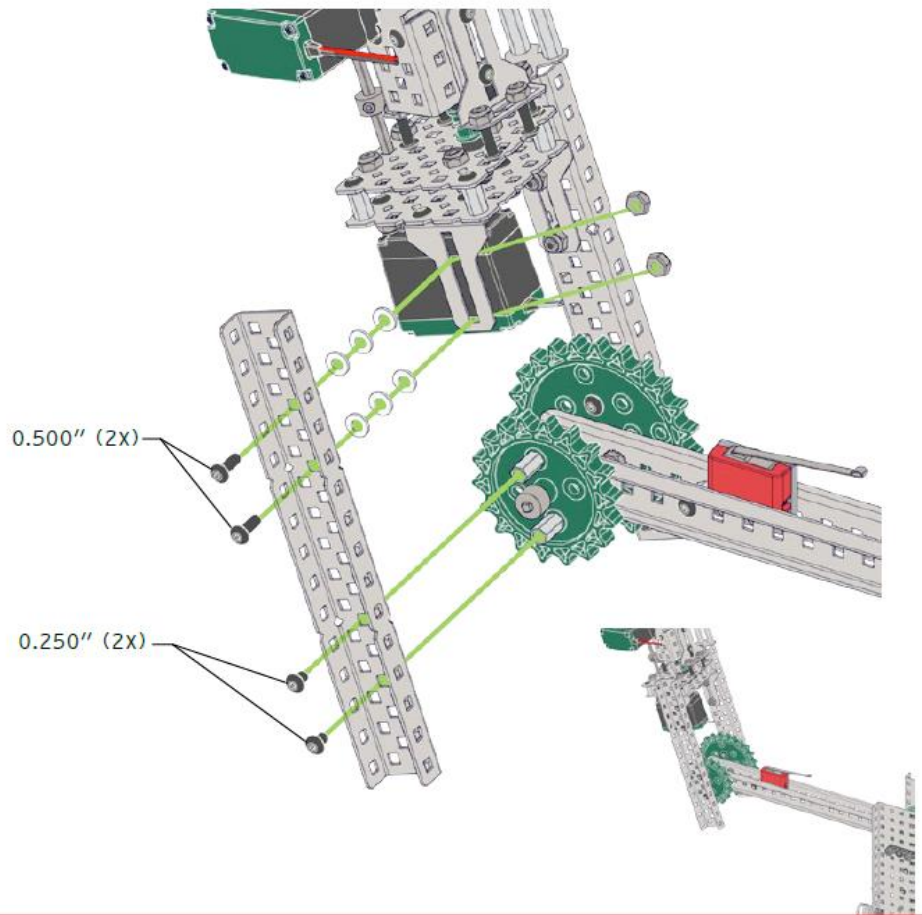

50

(72x)
High Strength Chain Link

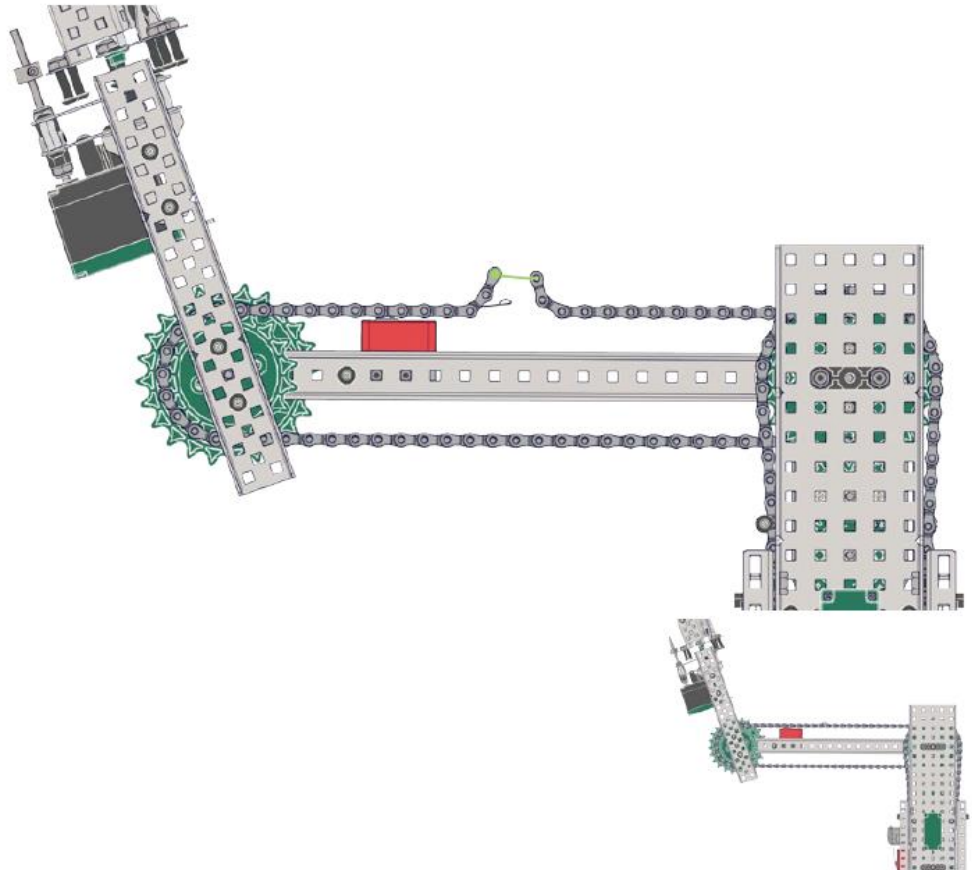
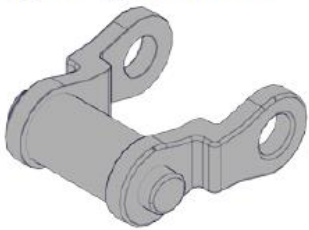



(2x)
Screw 8-32 x 0.375"

(2x)
Nut 8-32 Keps

(1x)
LCD Display

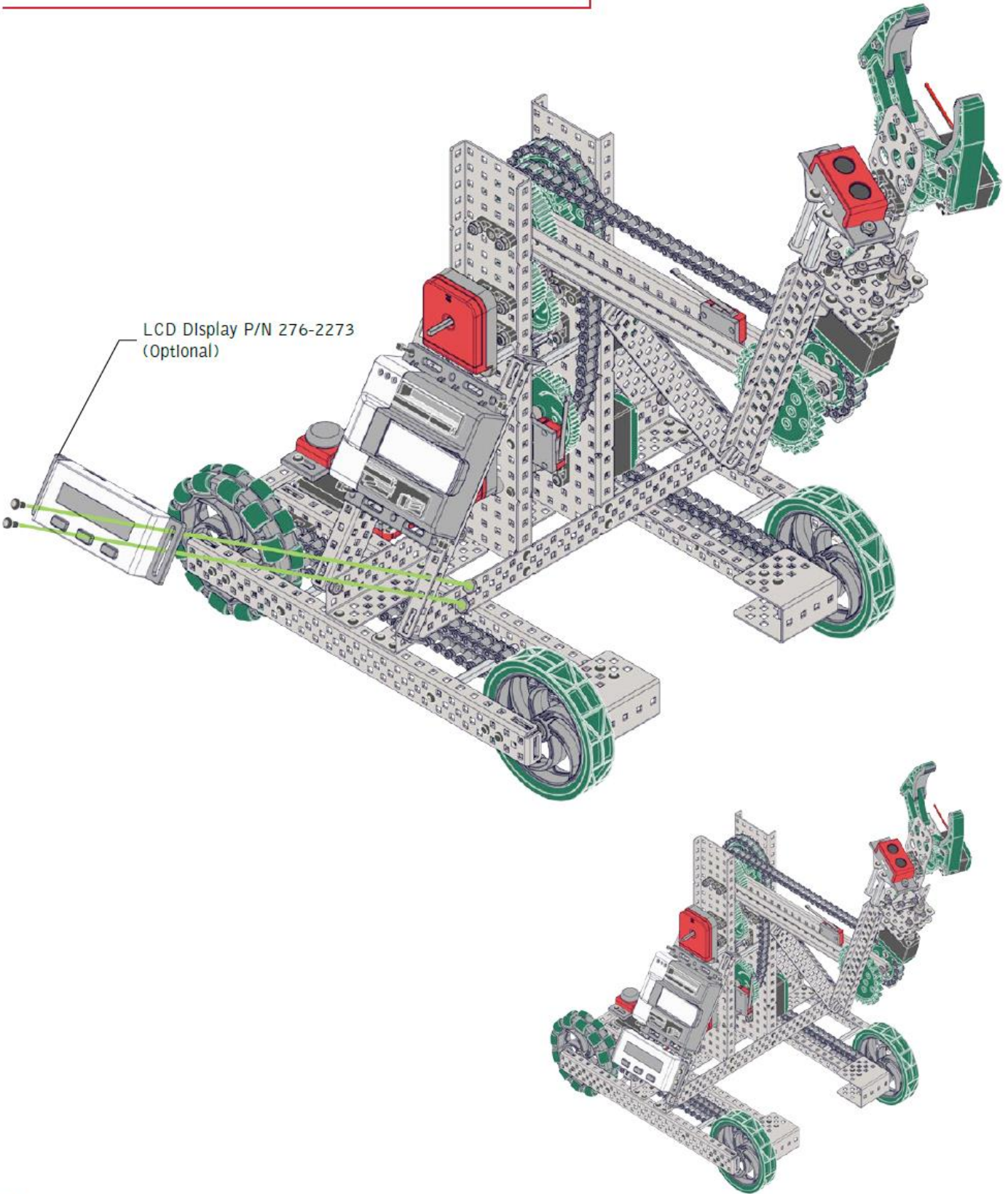

LCD Display P/N 276-2273
(Optional)



(4x) Screw 8-32 x 0.375"

4x Nut 8-32 Keps

(2x) Battery Strap

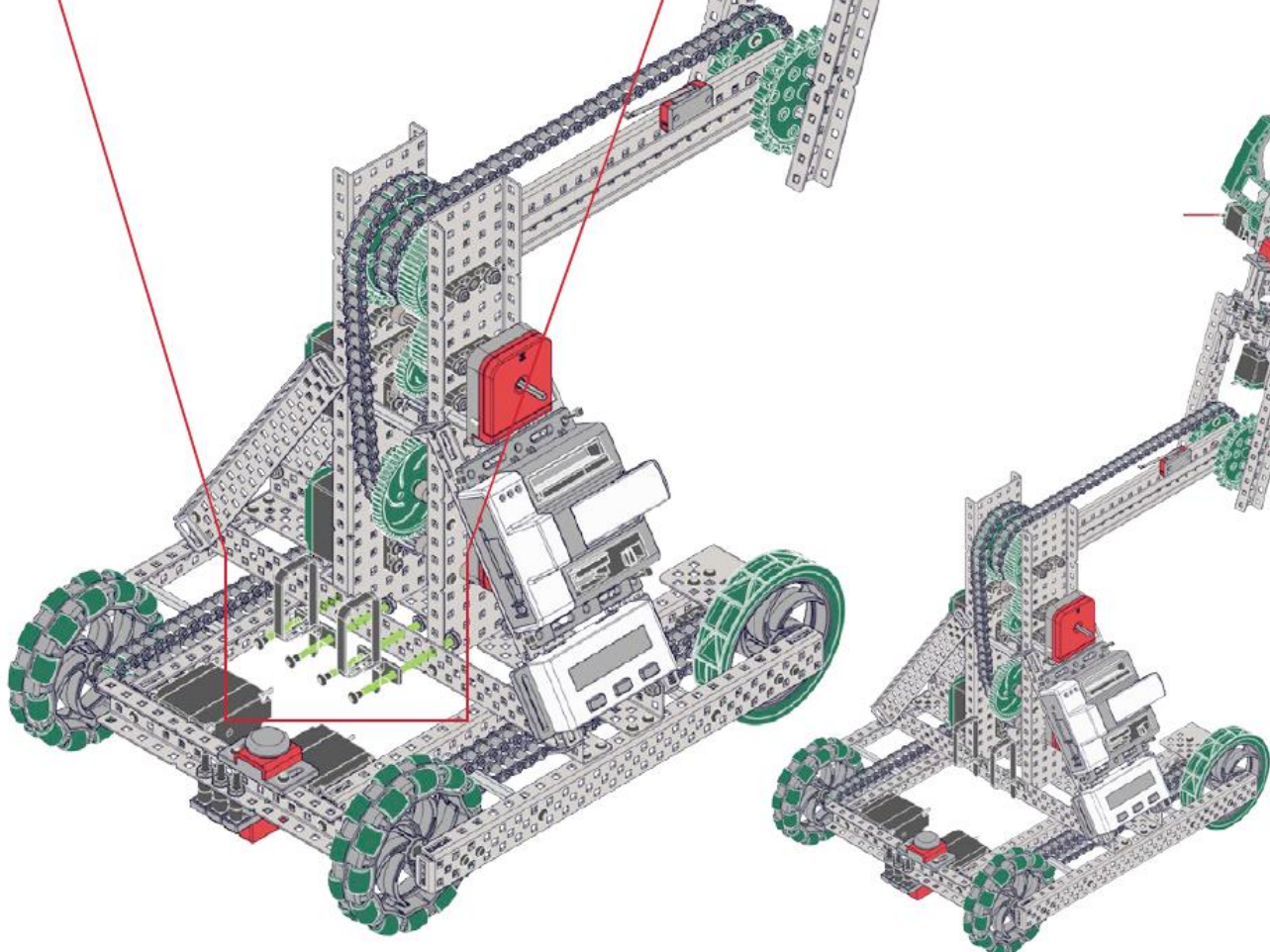
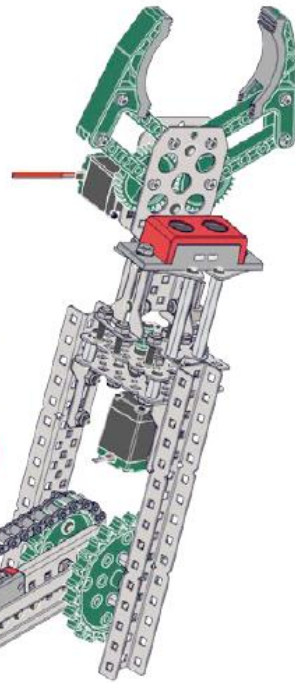
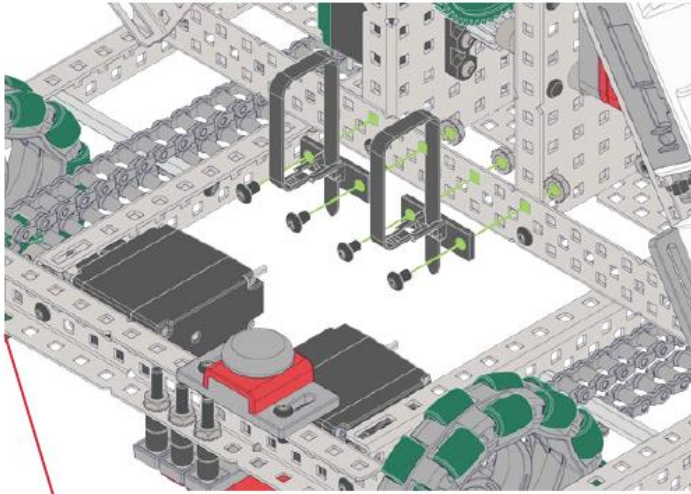

Motor

Wiring Diagram

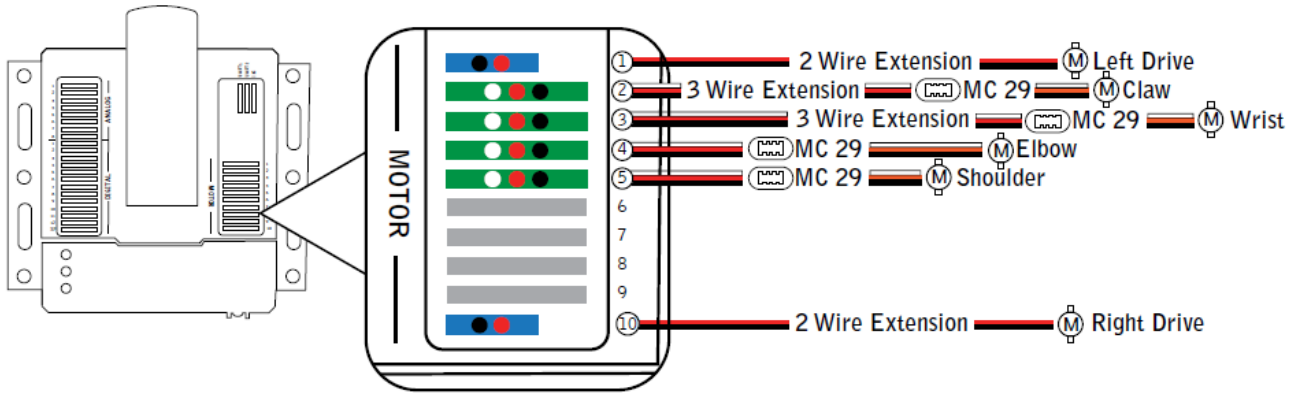

Digital

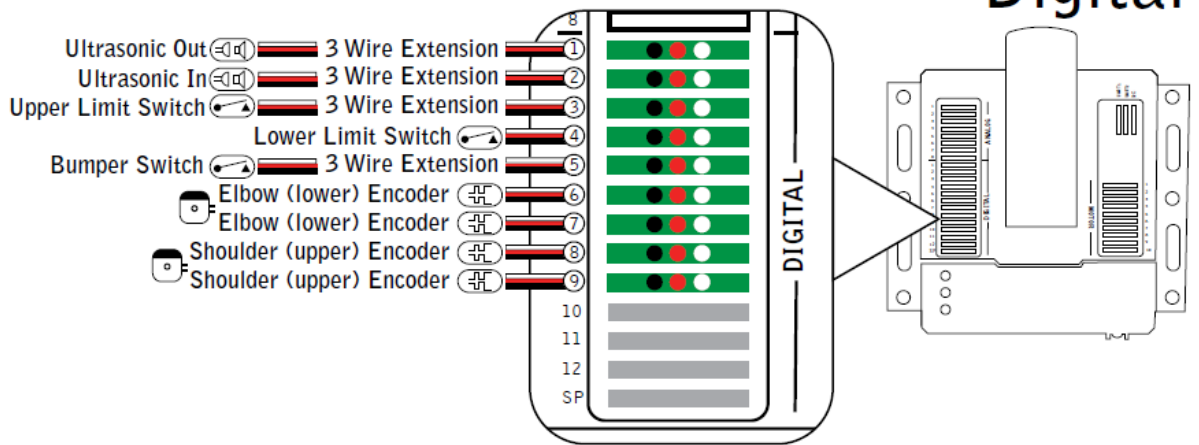

Analog

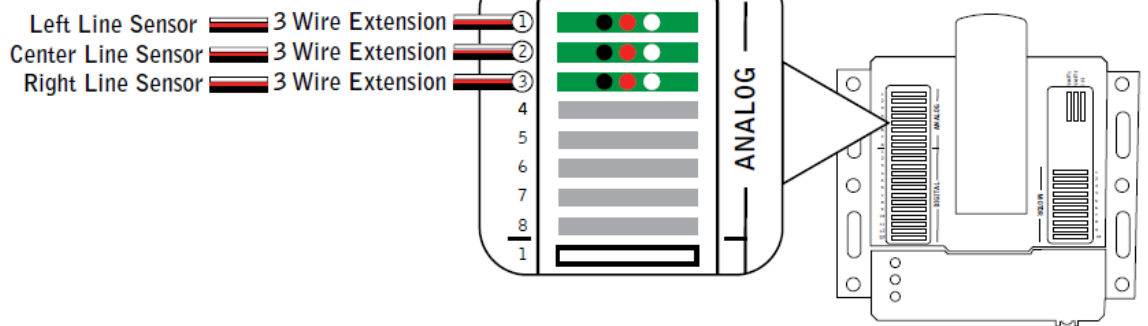

UART/I2C

